

ASSEMBLY

Clean the disassembled parts thoroughly with nonflammable or high flash point solvent before assembly.

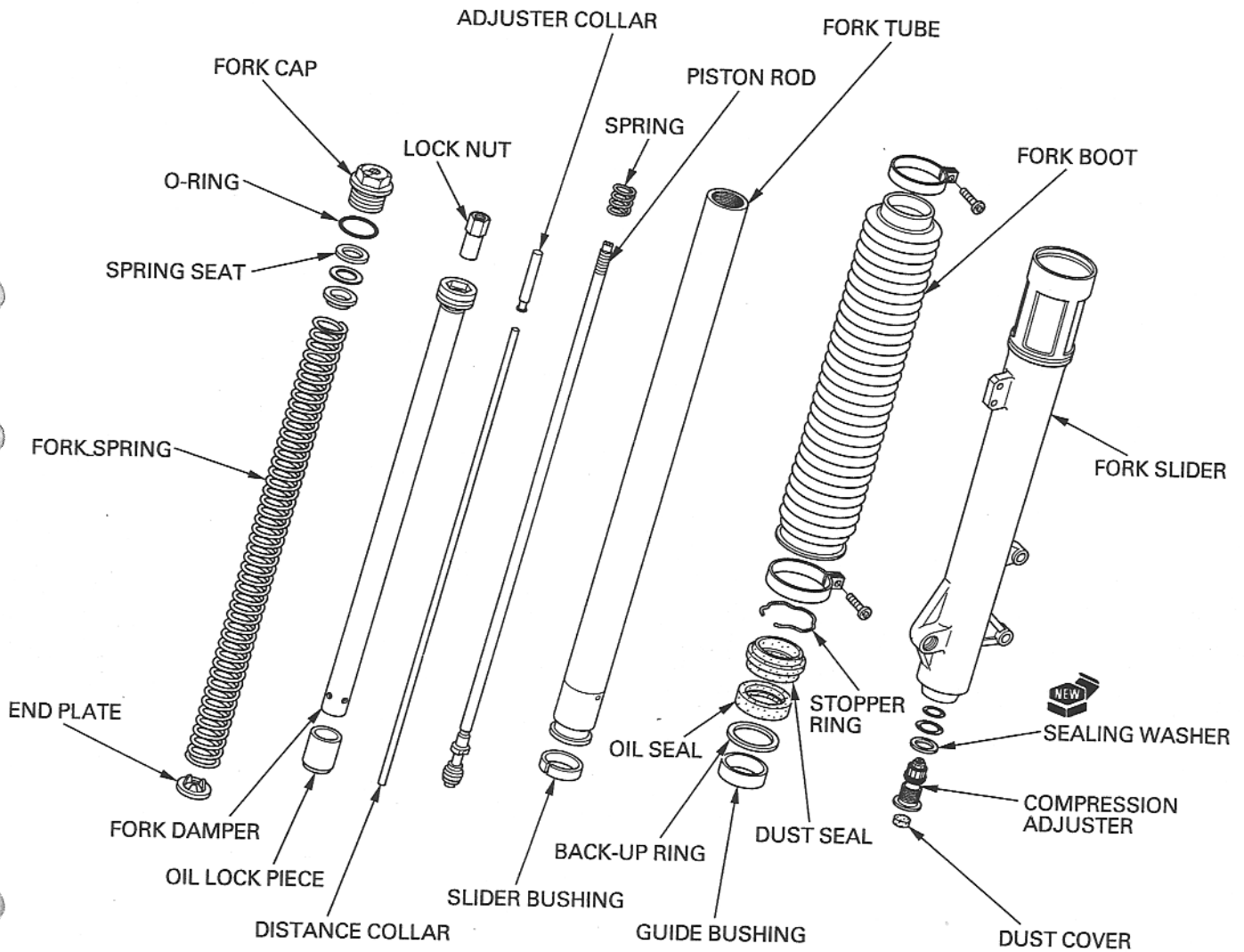

Install the following from the fork tube upper side:
 - Oil seal
 - Dust seal

Install the oil seal with its marked side facing the dust seal.

CAUTION:

Do not install the seals from the fork tube lower side, because it may damage the lips.

Install the following from the fork tube bottom side:
 - Back-up ring
 - Guide bushing
 - Slider bushing

Remove any burrs from the slider bushing, taking care not to peel off its coating.

