

Cassette Deck

Loading:

Push the eject button to open the cassette lid and slide the tape into the deck, following the inserting direction shown on the lid. Close the cassette lid.

CAUTION:

- ***Check there is no slack in the tape before inserting the cassette tape into the deck.***
- ***Make sure the lid is secured after inserting the cassette tape into the deck.***
- ***Do not open the cassette lid in the rain. Before opening the cassette lid, wipe off any dirt or water on the outer surface.***
- ***The use of 120-minute cassette tapes is not recommended. If necessary to use 120-minute tapes, do not switch the tape operation mode frequently. Most 120-minute tape stretches easily and can become tangled in the player mechanism.***

Eject Button:

The cassette is ejected from the deck when this button is depressed.

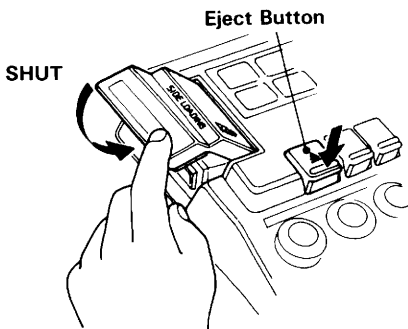

Inserting Direction

