

License Light Bulb

1. Remove the two bolts (1) and remove the license light assembly (2).

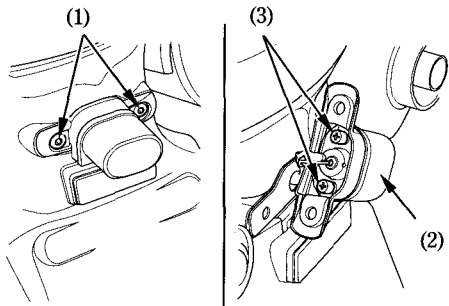

- (1) Bolts
- (2) License light assembly
- (3) Nuts

2. Remove the two nuts (3) and remove the license light cover (4) and license light lens (5).
3. Slightly press the bulb (6) and turn it counterclockwise.
4. Install a new bulb in the reverse order of removal.

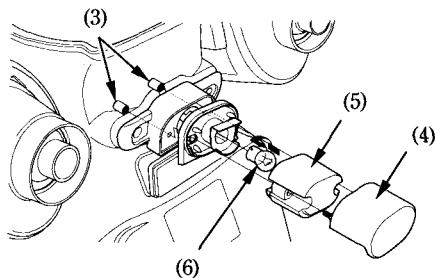

- (3) Nuts
- (4) License light cover
- (5) License light lens
- (6) Bulb