

Seat Removal

Rear Seat Removal

The rear seat must be removed to access the tool kit and owner's manual.

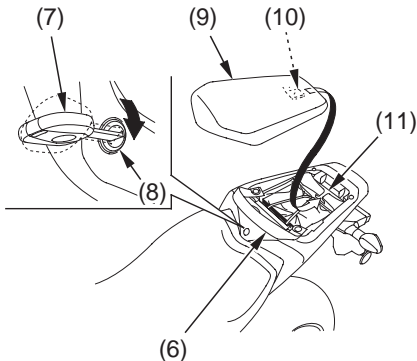

- | | |
|------------------|----------------|
| (6) seat strap | (9) rear seat |
| (7) ignition key | (10) prong |
| (8) seat lock | (11) seat hook |

Removal:

1. Move the seat strap (6) forward.
2. Insert the ignition key (7) into the seat lock (8). Turn it clockwise, then pull the rear seat (9) up and forward.

Installation:

1. To install the seat, insert the prong (10) into the seat hook (11), and then push down on the front of the seat.
2. Return the seat strap to its normal position.
Be sure the seat is locked securely in position after installation.