

D 3

E-7

Clutch
Embrayage
Kupplung
Embrague

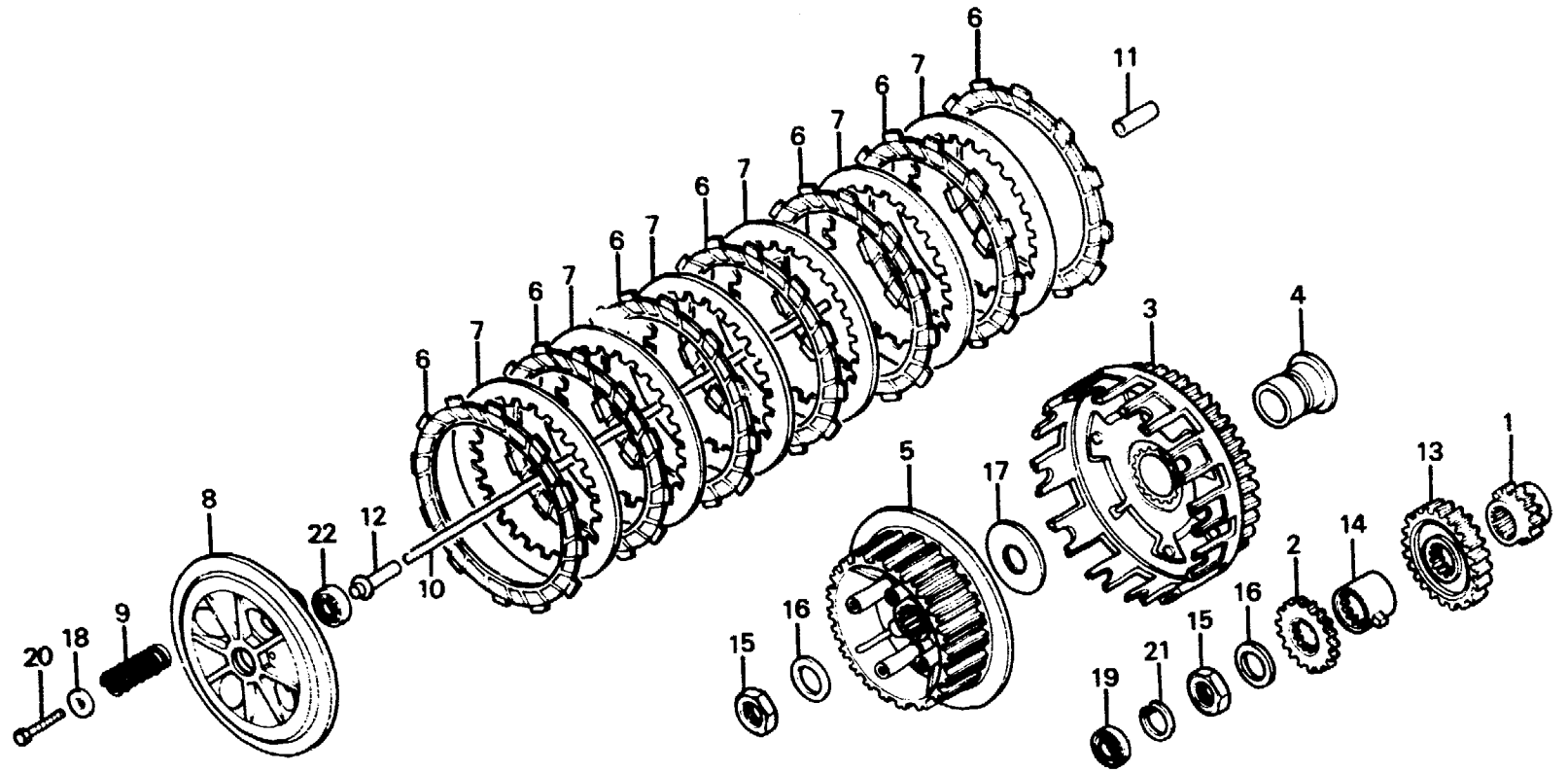

BMG2-4

Service item	F.R.T.	Ref. No.	Part No.	Description	Reqd. No. XL600						Serial No.	Area code
					Rd	Ld	Re	Le	Rf	Lf		
SPROCKET, TIMING	*4.0	1	14312-MG3-000	SPROCKET, TIMING (19T)	1	1	1	1	1	1		
GEAR, OIL PUMP DRIVE	0.7	2	15130-MG3-000	GEAR, OIL PUMP DRIVE (27T)	1	1	1	1	1	1		
• DISK, CLUTCH FRICTION (INC. RELATIVE PART) (ONE OR ALL)		3	22100-MG3-000	OUTER COMP., CLUTCH (70/16T)	1	1	1	1				
• PLATE, CLUTCH PRESSURE OUTER COMP., CLUTCH	0.8	* 4	22100-MG2-790	OUTER COMP., CLUTCH					1	1		
• CENTER COMP., CLUTCH SPRINC. CLUTCH (ONE OR ALL)	0.6	5	22116-MG3-000	GUIDE, CLUTCH OUTER	1	1	1	1	1	1		
• OIL SEAL, 14X22X5		6	22120-MG3-000	CENTER COMP., CLUTCH	1	1	1	1	1	1		
ROD, CLUTCH LIFTER	0.4	7	22201-MG3-000	DISK, CLUTCH FRICTION	7	7	7	7	7	7		
GEAR, PRIMARY DRIVE	0.9	8	22321-MG3-000	PLATE, CLUTCH	6	6	6	6	6	6		
		9	22350-MG3-000	PLATE, CLUTCH PRESSURE	1	1	1	1	1	1		
		10	22401-MG3-000	SPRING, CLUTCH	4	4	4	4	4	4		
		11	22850-MG3-000	ROD, CLUTCH LIFTER	1	1	1	1	1	1		
		12	22852-MG3-000	PIECE A, SHIFT	1	1	1	1	1	1		
		13	22853-MG3-000	LIFTER COMP., CLUTCH	1	1	1	1	1	1		
			23121-MG2-000	GEAR, PRIMARY DRIVE (32T)	1	1	1	1	1	1		