

C 10

E-3

Left cylinder head

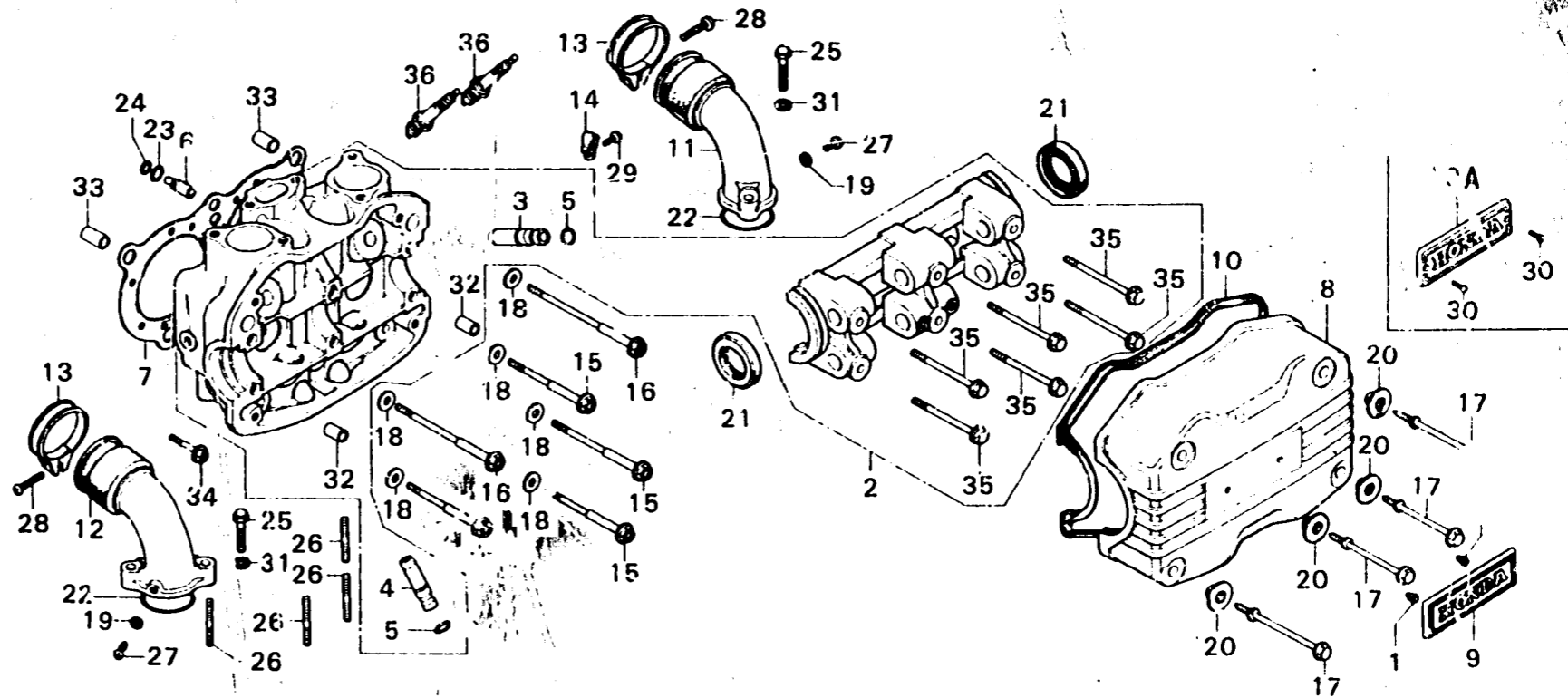

B371-3

Service item	F.R.T.	Ref. No.	Part No.	Description	Reqd. No.		Serial No.	Area code
					GL1000	GL1000 LTD K1 K2		
			90081-371-980	WASHER, PLAIN, 6MM		4		
		32	94301-10160	PIN A, DOWEL, 10X16	2	2	2	2
		33	94301-12200	PIN A, DOWEL, 12X20	2	2	2	2
		34	95700-06028-00	BOLT, FLANGE, 6X28	1		1	1
			90144-371-980	BOLT, FLANGE, 6X28		1		
		35	95700-0070-00	BOLT, FLANGE, 8X70	6	6	6	6
		36	98069-710	PLUG, SPARK (D-8ES-L NGK)	2	2	2	2
			98069-58721	PLUG, SPARK (X24ES ND)	2	2	2	
			98069-38716	PLUG, SPARK (DR8ES-L NGK)		2	2	2
			98069-58726	PLUG, SPARK (X24ESR-U ND)				2
			98069-58727	PLUG, SPARK (X24ES-U ND)				2
							3026566	A,DK,DM,U CM A,CM,DK,DM,U E,ED,F,G
							3026567	CM CM,E,ED,F,G A,DK,DM,U

1979.04.10

C10