

E 1

E-11

**Cylinder block
Breather chamber**

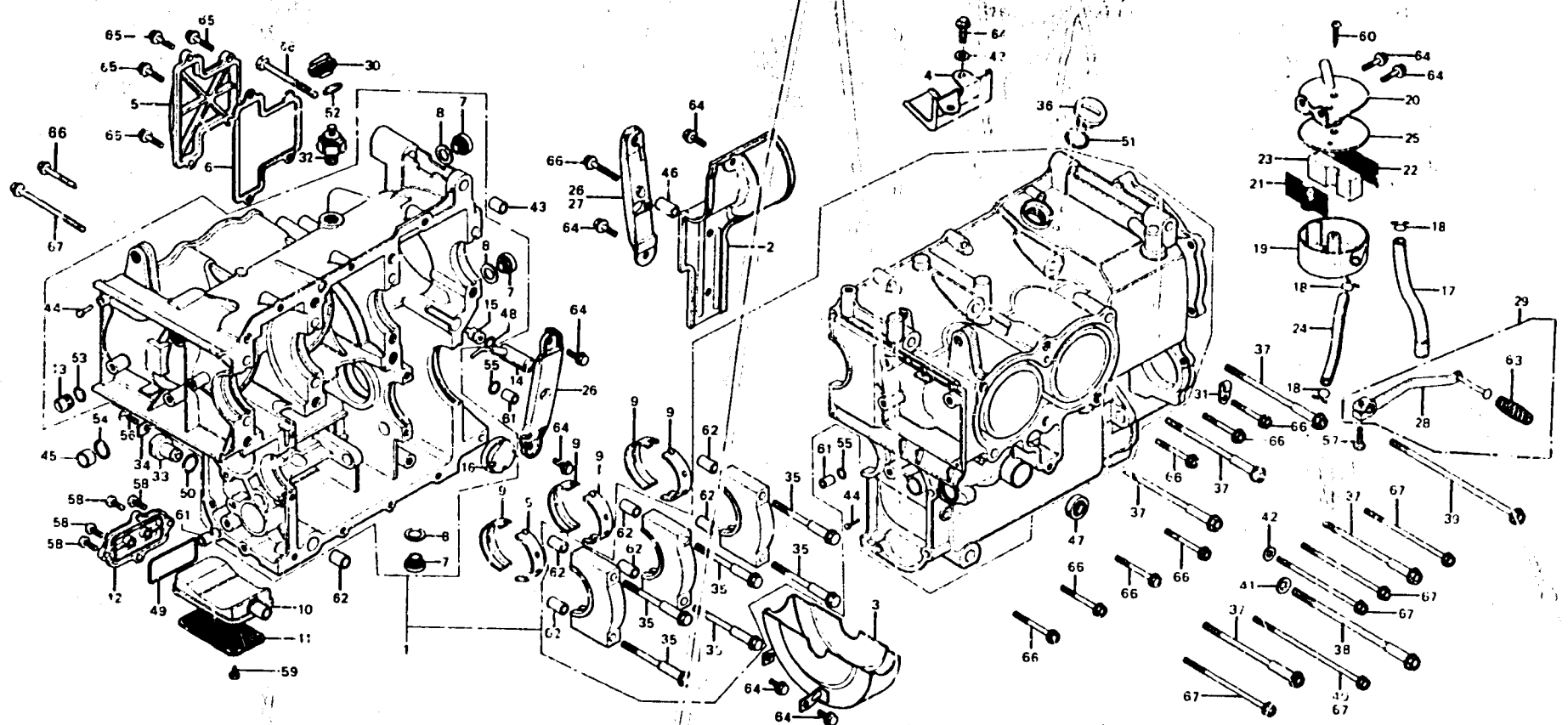

B371-11

Service item	F.R.T.	Ref. No.	Part No.	Description	Reqd. No.				Serial No.	Area code
					GL1000	GL1000 LTD	K1	K2		
		55	91361-706-000	O-RING, 8X1.9	2	2	2	2		
		56	92000-06016	BOLT, HEX., 6X16	1		1	1		
			90041-371-980	BOLT, HEX., 6X16			1			
		57	92000-06020	BOLT, HEX., 6X20	1		1	1		
			90042-371-980	BOLT, HEX., 6X20			1			
		58	93500-06020	SCREW, PAN, 6X20	4		4	4		
			90044-371-980	SCREW, PAN, 6X20			4			
		59	93901-12110	SCREW, TAPPING, 3X8	3	3	3	3		
		60	93901-15410	SCREW, TAPPING, 5X20	1		1	3		
			90061-371-980	SCREW, TAPPING, 5X20			1			
		61	94301-08140	PIN A, DOWEL, 3X.4	4	4	4	4		
		62	94301-12200	PIN A, DOWEL, 12X20	7	7	7	7		
		63	95011-40000	RUBBER, CHANGE PEDAL	1					
			24781-371-000	RUBBER, CHANGE PEDAL			1		2002958	2002957 E,ED,F,G E,ED,F,G A,CM,DK,DM,U
		64	95700-06016-00	BOLT, FLANGE, 6X16	9	7		11		
							9			
							11		2002860	2002859 E,ED,F,G A,CM,DK,DM,U E,ED,F,G
							11			
			90141-371-980	BOLT, FLANGE, 6X16		4				
		65	95700-06025-00	BOLT, FLANGE, 6X25	4		4	4		
			90143-371-980	BOLT, FLANGE, 6X25		4				
		66	95700-06035-00	BOLT, FLANGE, 6X35	9		9	9		
			90146-371-980	BOLT, FLANGE, 6X35		9				

1979.04.10

E1