

E 16

E-15-1

**Carburetor
(Component parts)**

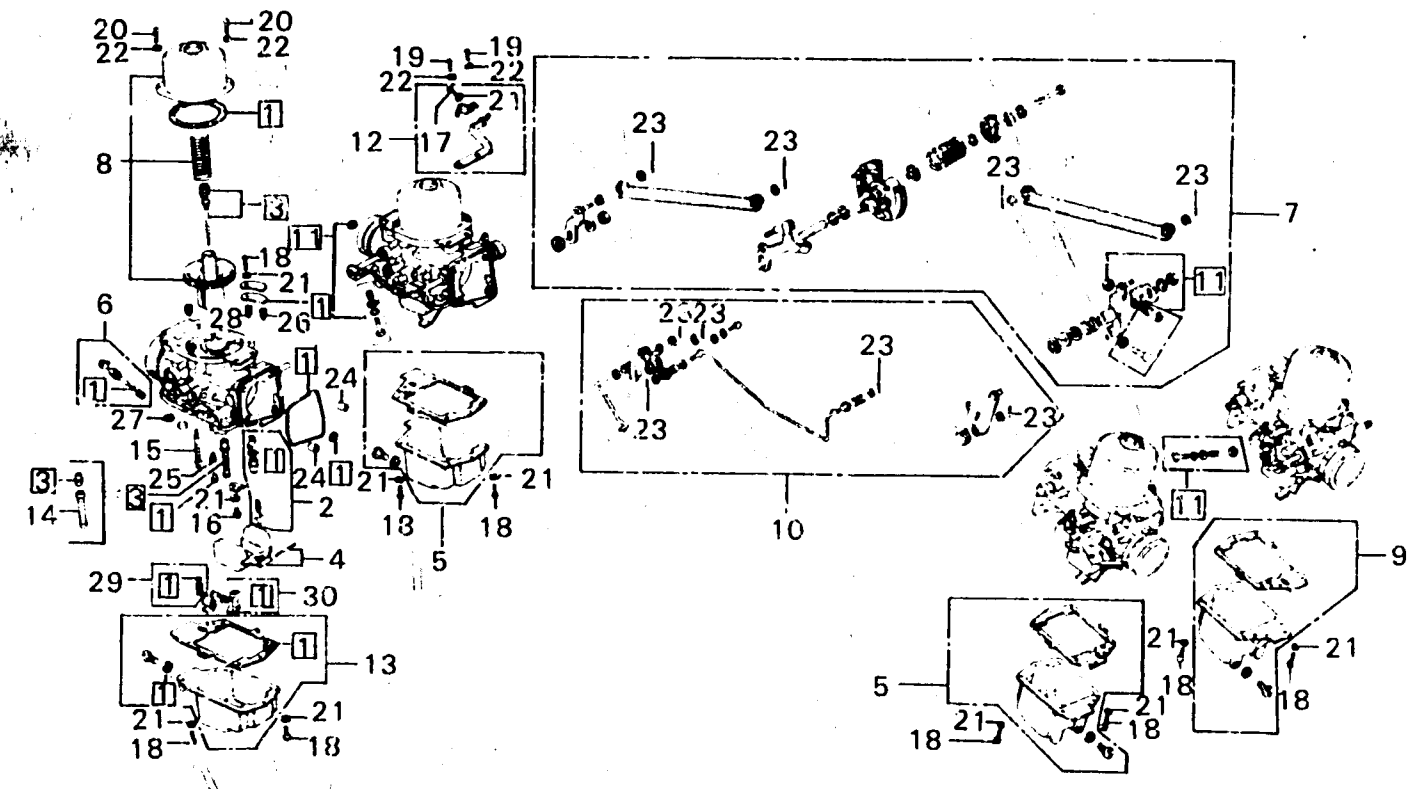

B371-15C

Service item	F.R.T.	Ref. No.	Part No.	Description	Reqd. No.			Serial No.	Area code
					GL1000	GL1000 LTD K1	K2		
			16025-371-771	ROD SET, CHOKE		1	2012647	E,ED,F,G	
			16025-371-980	ROD SET, CHOKE		1		A,CM,DK,DM,U	
		11	16028-371-004	SCREW SET B	3	3		E,ED,F,G	
		12	16035-371-004	PLATE SET, STAY	1	1		A,CM,DK,DM,U	
		13	16045-371-004	CHAMBER SET C, FLOAT	1	1		E,ED,F,G	
		14	16165-371-770	HOLDER, NEEDLE JET				A,CM,DK,DM,U	
		15	16166-371-004	NOZZLE, MAIN	4	4		A,CM,DK,DM,U	
			16166-371-770	NOZZLE, MAIN		4		E,ED,F,G	
						4		A,CM,DK,DM,U	
		16	93500-04008-01A	SCREW, PAN, 4X8	4	4			
		17	93500-04010-01A	SCREW, PAN, 4X10	1	1			
		18	93500-04014-JA	SCREW, PAN, 4X14	20	20			
		19	93500-05012-0A	SCREW, PAN, 5X12	2	2			
		20	93500-05016-0A	SCREW, PAN, 5X16	8	8			
			90052-371-780	SCREW, PAN, 5X16		8			
		21	94111-04000	WASHER, SPRING, 4M14	25	25			
		22	94111-05000	WASHER, SPRING, 5M14	10	10			
			90085-371-980	WASHER, SPRING, 5M14		10			
		23	94201-10080	PIN, SPLIT, 1,0X8	5				
						5			
						9			
						9			
						9	2012647	E,ED,F,G	
							2012646	E,ED,F,G	
								A,CM,DK,DM,U	

1979.04.10

E16