

G 6

F-2

Handle lever • Cable • Switch

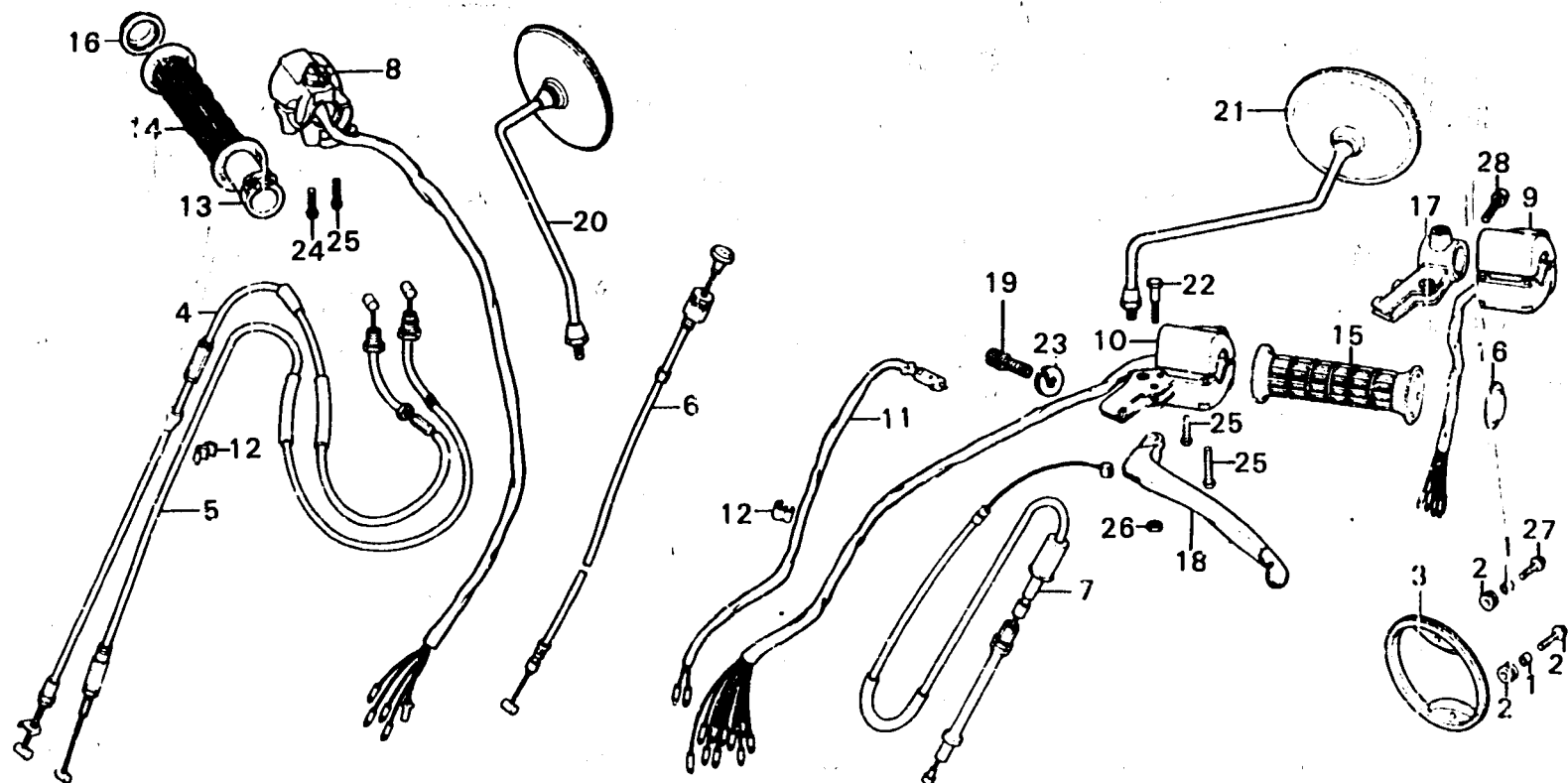

B371-17B

Service item	F.R.T.	Ref. No.	Part No.	Description	Reqd. No.				Serial No.	Area code
					GL1000	GL1000	LTD	K1 K2		
CLUTCH CABLE COMP.	1.2	1	11346-371-300	COLLAR, ADJUST COVER	2	2	2	2		
THROTTLE CABLE	0.8	2	11347-371-300	GROMMET, ADJUST COVER	2	2	2	2		
•One or all		3	11348-371-000	COVER, CLUTCH ADJUST	1		1	1		
WINKER SWITCH ASSY.	0.5		11348-371-980	COVER, CLUTCH ADJUST		1				
•L. HANDLE LEVER BRACKET		4	17910-371-000	CABLE COMP., A, THROTTLE	1		1			A, CM, DK, DM, U
STARTER KILL SWITCH ASSY.	0.4		17910-371-980	CABLE COMP., A, THROTTLE		1				A, CM, U
CLUTCH LEVER SWITCH	0.2		17910-371-960	CABLE COMP., A, THROTTLE		1				ED, F, G
•CLUTCH ADJUSTING COVER			17910-371-610	CABLE COMP., A, THROTTLE			1	1		E, ED, F, G
•CHOKE CABLE		5	17910-371-660	CABLE COMP., A, THROTTLE				1		A, CM, DK, DM, U
•THROTTLE GRIP PIPE			17920-371-000	CABLE COMP., B, THROTTLE	1		1			A, CM, DK, DM, U
GRIP RUBBER	0.1		17920-371-980	CABLE COMP., B, THROTTLE		1				A, CM, U
•HANDLE LEVER			17920-371-960	CABLE COMP., B, THROTTLE			1			ED, F, G
BACK MIRROR	0.1		17920-371-610	CABLE COMP., B, THROTTLE			1	1		E, ED, F, G
•One or all			17920-371-660	CABLE COMP., B, THROTTLE				1		A, CM, DK, DM, U
		6	17950-371-000	CABLE COMP., CHOKE	1					
			17950-371-010	CABLE COMP., CHOKE		1			2002808	DK, DM, E, ED, F, G, U
					1					ED, F, G, U
						1		2002809		DK, DM, E, ED, F, G, U
					1	1	1			A, CM
							1			DK, DM, E, ED, F, G, U
		7	22870-371-000	CABLE COMP., CLUTCH	1				1002457	A
			22870-371-305	CABLE ASSY., CLUTCH	1				1002457	A
			22870-371-010	CABLE COMP., CLUTCH	1					
			22870-371-020	CABLE COMP., CLUTCH	1			1002458		A
							1		2025241	DK, DM, U
										A, DK, DM, U

1979.04.10

G6