

G 7

F-2

Handle lever • Cable • Switch

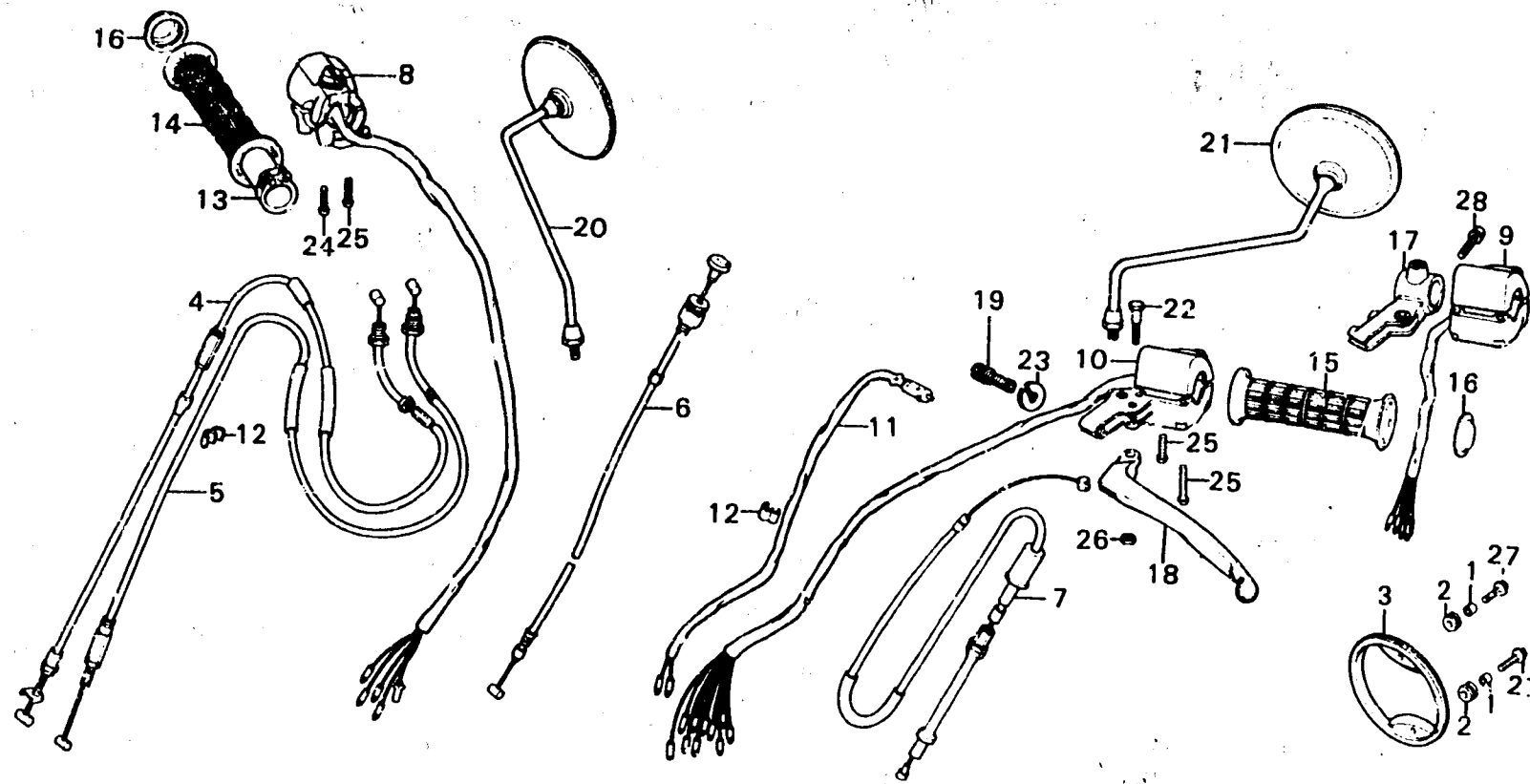

B371-17B

Service item	F.R.T.	Ref. No.	Part No.	Description	Reqd. No.		Serial No.	Area code
					GL1000	GL1000 LTD K1 K2		
			22870-371-020	CABLE COMP., CLUTCH		1	2025242	A,DK,DM,U
			22870-371-980	CABLE COMP., CLUTCH	1	1		CM
			22870-371-610	CABLE COMP., CLUTCH		1	2025721	A,CM,U
			22870-371-611	22870-371-611 CABLE COMP., CLUTCH	1	1		E,ED,F,G
			22870-371-660	CABLE COMP., CLUTCH		1	2025722	E,ED,F,G
		8	35150-371-003	SWITCH ASSY., STARTER KILL	1	1		E,ED,F,G
			35150-371-670	SWITCH ASSY., STARTER KILL	1	1		A,CM
			35150-371-980	SWITCH ASSY., STARTER KILL		1		DK,DM,U
			35150-371-910	SWITCH ASSY., STARTER KILL		1		A,CM
			35150-371-601	SWITCH ASSY., STARTER KILL		1		U
			35150-371-660	SWITCH ASSY., STARTER KILL		1		E,ED,F,G
			35150-371-651	SWITCH ASSY., STARTER KILL		1		A,CM
		9	35200-371-013	SWITCH ASSY., WINKER HORN		1	2016001	DK,DM,U
				PASSING		1		DK,DM,U
			35200-371-602	SWITCH ASSY., TURN SIGNAL, HORN, PASSING		1		E,ED,F,G
			35200-371-671	SWITCH ASSY., TURN SIGNAL HORN		1	2016001	E,ED,F,G
						1	2016001	A
			35200-371-910	SWITCH ASSY., WINKER HORN		1		CM
				PASSING		1		U
			35200-371-980	SWITCH ASSY., WINKER		1		A,CM
			35200-371-660	SWITCH ASSY., WINKER HORN		1		A,CM
		10	35200-371-670	SWITCH ASSY., WINKER HORN	1	1		A
						1	2016000	A

1979.04.10

67