

**H 12**

**F-7**

**Front fender**

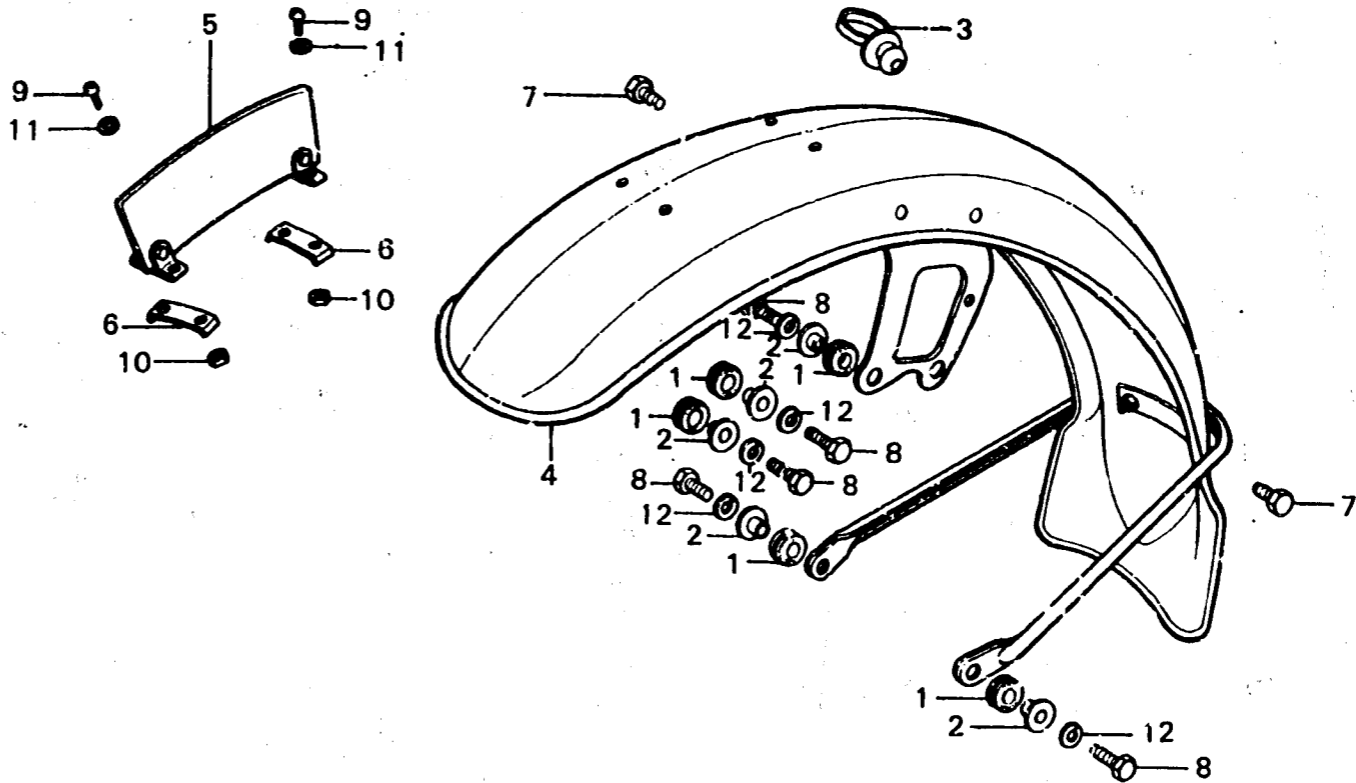

B371-22

Service item	F.R.T.	Ref. No.	Part No.	Description	Reqd. No.				Serial No.	Area code	
					GL1000	GL1000	LTD	K1 K2			
FRONT FENDER COMP. •E, TYPE at 0.4 WIRE GROMMET •FRONT FENDER PLATE	0.3	1	40513-310-000	RUBBER, CHAIN CASE MOUNT	6	6	6	6			
		2	40514-310-000	COLLAR, CHAIN CASE	6		6	6			
	0.1	3	40514-371-980	COLLAR, CHAIN CASE			6				
		3	45451-283-000	GROMMET, WIRE	1	1					
				45451-367-690	GROMMET, WIRE			1		2040166 2040165	DK,DM,E,ED,F,G,U
			4	61100-371-000	FENDER COMP., FR.	1	1	1		2012211	A,CM,DK,DM,FD,F,G,U
				61100-371-600	FENDER COMP., FR.			1			E
				61100-371-980	FENDER COMP., FR.			1		2012210	E
			5	61131-268-600B	PLATE, FR. NUMBER		1			2012210	E
			6	61134-315-600	WASHER, FR. NUMBER PLATE			2		2012210	E
			7	92000-06010	BOLT, HEX., 6X10	2	2	2	2		
			8	92000-06020	BOLT, HEX., 6X20	6		6	6		
			91503-371-980	BOLT, HEX., 6X20		6					
		9	93500-04012-0A	SCREW, PAN, 4X12			4		2012210	E	
		10	94001-04000-0S	NUT, HEX., 4MM			4		2012210	E	
		11	94111-04000	WASHER, SPRING, 4MM			4		2012210	E	
		12	94111-06000	WASHER, SPRING, 6MM	6		6	6	2012210	E	
			91561-371-980	WASHER, SPRING, 6MM		6					

1979.04.10

H12