

**I 6**

**F-12**

**Rear wheel • Disk**

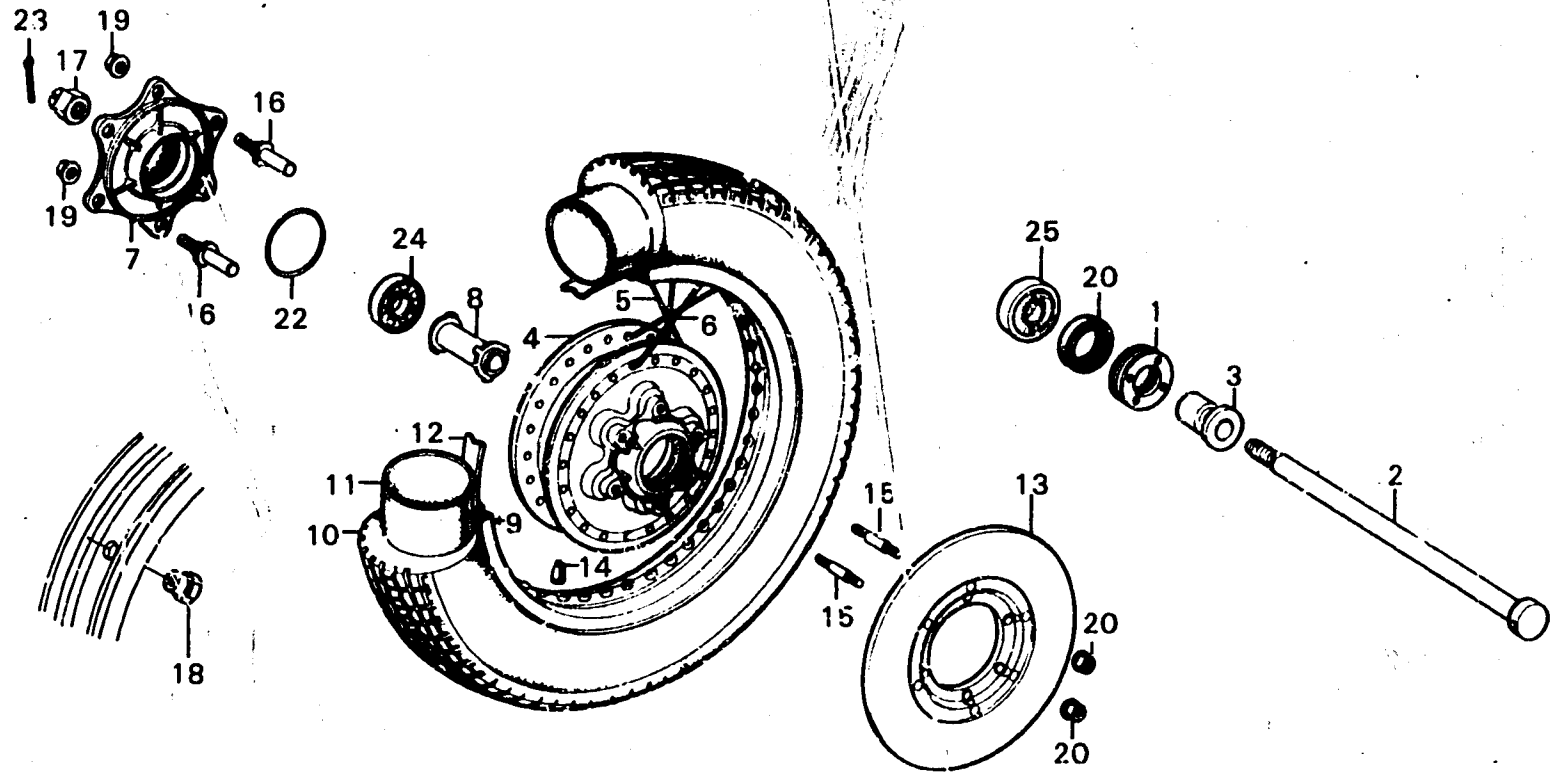

B371-27

Service item	F.R.T.	Ref. No.	Part No.	Description	Reqd. No.				Serial No.	Area code
					GL1000	GL1000	LTDK1	K2		
REAR WHEEL HUB	3.4	1	41231-286-000	RETAINER, RR, WHEEL BEARING	1	1	1	1		
REAR WHEEL RIM	2.4	2	42301-371-000	AXLE, RR, WHEEL	1		1	1		
REAR WHEEL TIRE/TUBE/TIRE FLAP	1.1		42301-371-980	AXLE, RR, WHEEL			1			
BALANCER	0.9	3	42311-356-000	COLLAR, RR, WHEEL SIDE	1	1	1	1		
REAR AXLE DISTANCE COLLAR/BALL BEARING	0.6	4	42601-371-305	HUB ASSY., RR, WHEEL	1		1	1		
			42601-371-315	HUB ASSY., RR, WHEEL	1		1	1		
			42060-371-980	HUB ASSY., RR, WHEEL		1				
FINAL DRIVEN FLANGE	0.6	5	42606-371-305	SPOKE ASSY., A, RR, (INSIDE)	20		20	20		
•8 x 45 STUD BOLT			42660-371-980	SPOKE A, RR, (INSIDE)			20			
REAR WHEEL BEARING RETAINER/DUST SEAL	0.5	6	42607-371-305	SPOKE ASSY., B, RR, (OUTSIDE)	20		20	20		
•REAR BRAKE DISK COMP.			42670-371-980	SPOKE B, RR, (OUTSIDE)			20			
REAR WHEEL AXLE	0.4	7	42610-371-000	FLANGE, FINAL DRIVEN	1	1	1	1		
		8	42620-371-000	COLLAR A, RR, WHEEL DISTANCE	1	1	1	1		
		9	42701-371-003	RIM, RR, WHEEL (DAIDO)	1		1	1		
			42701-371-980	RIM, RR, WHEEL			1			
		10	42711-371-673	TIRE, RR, (4.50H-17A, BS)	1	1	1	1		A, CM, DK, DM, U
			42711-371-674	TIRE, RR, (4.50H-17A, DUNLOP)	1	1	1	1		A, CM, DK, DM, U
			42711-371-612	TIRE, RR, (4.50H-17A, DUNLOP)			1	1		E, ED, F, G
		11	42712-371-003	TUBE, TIRE (4.50-17, BS)	1	1	1	1		A, CM, DK, DM, U
			42712-371-004	TUBE, TIRE (4.50-17, DUNLOP)	1	1	1	1		
		12	42713-371-000	BAND, RIM (17)	1	1	1	1		
		13	43120-371-000	DISK COMP., RR, BRAKE	1	1	1	1		
		14	44606-283-000	BALANCER (20G)	N	N	N	N		
			44607-283-000	BALANCER (15G)	N	N	N	N		

1979.04.10

16