

**L 7**

**F-29**

Frame body

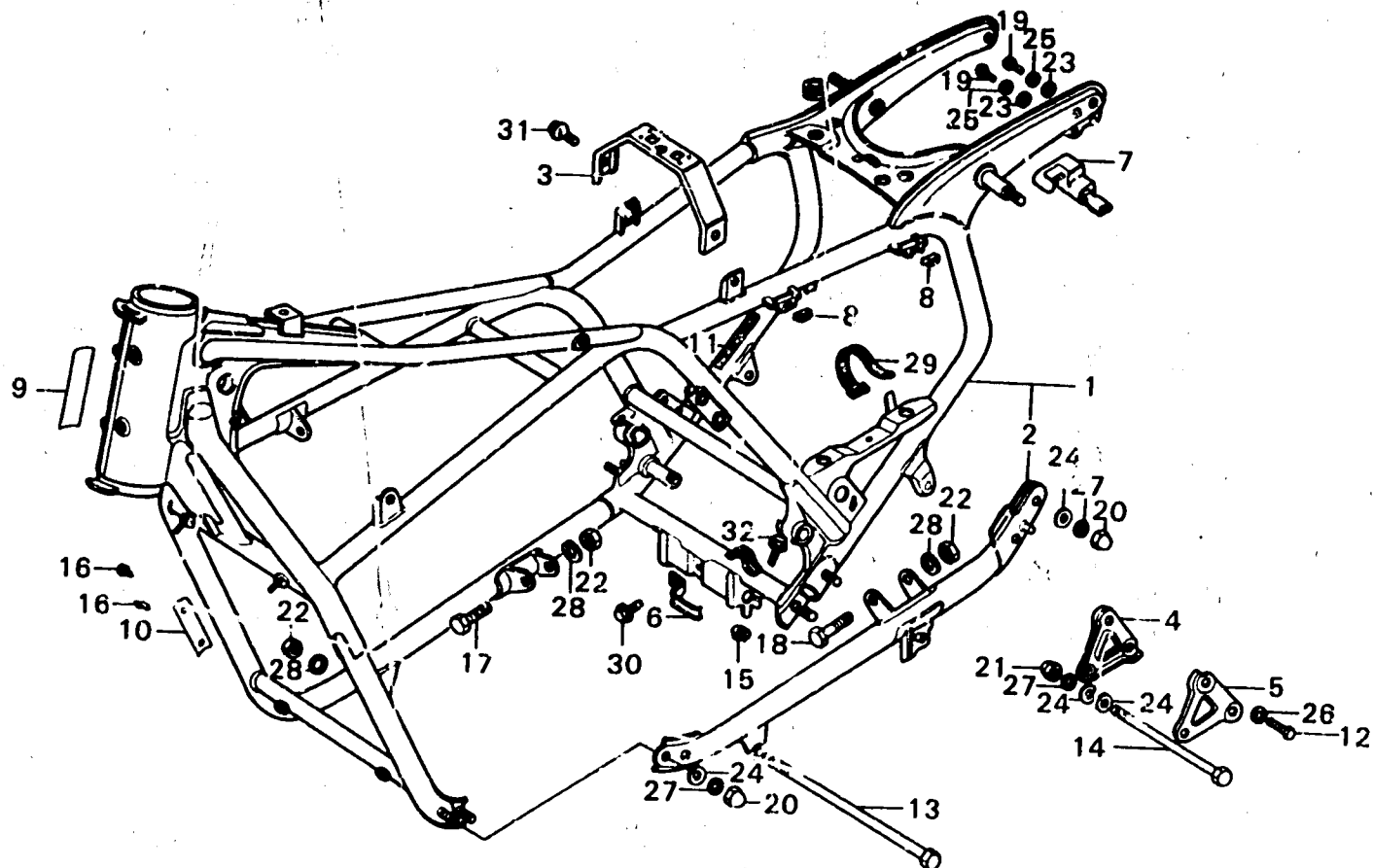

B371-44

Service item	F.R.T.	Ref. No.	Part No.	Description	Reqd. No.			Serial No.	Area code
					GL1000	GL1000	LTD K1 K2		
			50710-371-003	HOLDER ASSY., HELMET (TOYO)		2	2016001	2040165	E,ED,F,G
			50710-371-007	HOLDER ASSY., HELMET (HONDA LOCK)		2		2040166	
		8	83610-371-000	RUBBER, SIDE COVER SET	4	4	4	4	
		9	87125-041-680	PLATE, NAME	1		1	1	DK,DM
		20	87501-371-610	PLATE, REGISTERED NUMBER	1		1	1	U E,ED,F,G
		11	87504-028-670	MARK, MUFFLER CAUTION	1		1		A
			87504-371-670	MARK, MUFFLER CAUTION			1	2008914	2008913 A A CM A,CM
		12	90101-605-000	BOLT, SEAT BACK ADJUST	4		4	4	
			90101-371-980	BOLT, SEAT BACK ADJUSTING		4		4	
		13	90152-371-000	BOLT, FR. ENGINE HANGER	1		1	1	
			90152-371-980	BOLT, FR. ENGINE HANGER		1		1	
		14	90153-371-000	BOLT, ENGINE UPPER HANGER	1		1	1	
			90153-371-980	BOLT, UPPER ENGINE HANGER		1		1	
		15	90236-300-000	NUT, FLANGE, 8MM	2	2	2	2	
		16	90841-001-000	SCREW, RIVET, 1.5X5		2	2	2	E,ED,F,G
		17	92200-12065-0A	BOLT, HEX., 12X65	1		1	1	
			91507-371-980	BOLT, HEX., 12X65		1		1	
		18	92200-12080-0A	BOLT, HEX., 12X80	1		1	1	
			91508-371-980	BOLT, HEX., 12X80		1		1	

1979.04.10

L7