

## 2. REAR BRAKE AND REAR WHEEL

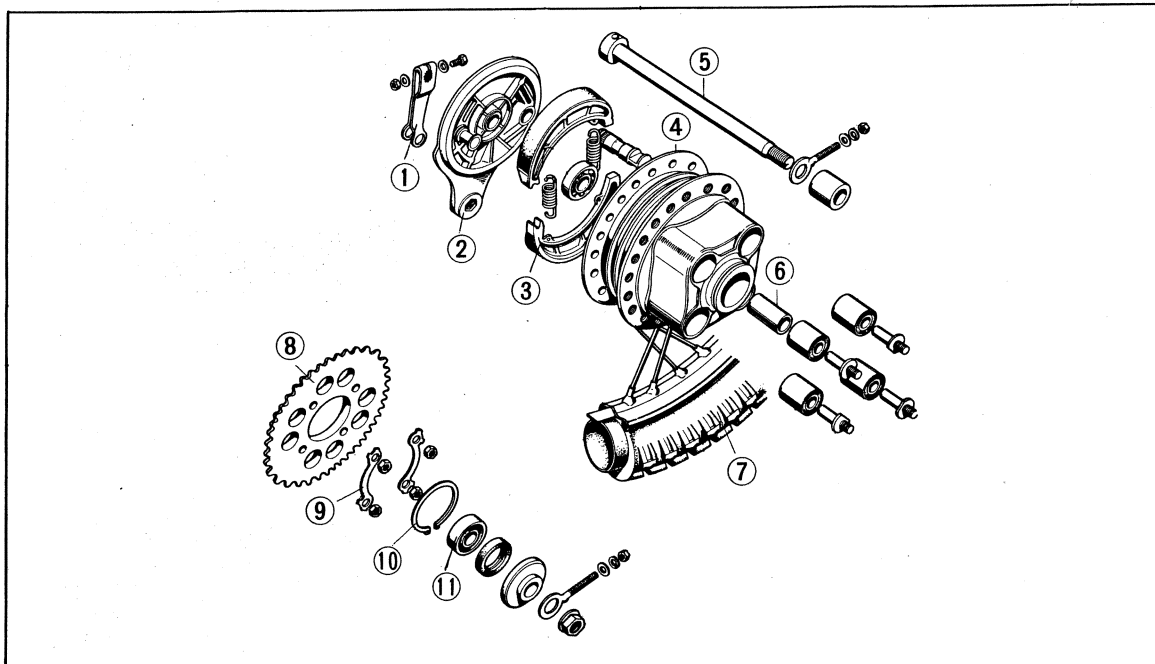

**Fig. 109** ① Rear brake arm ② Rear brake panel ③ Brake shoe ④ Rear wheel hub ⑤ Rear wheel axle ⑥ Rear axle distance collar ⑦ Rear wheel tire ⑧ Final driven sprocket ⑨ 8 mm tongued washer ⑩ 58 mm circlip ⑪ 6302R ball bearing

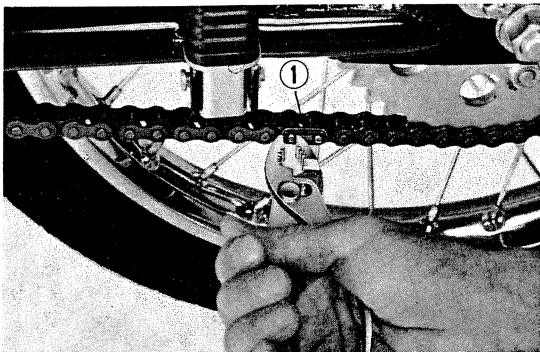

**Fig. 110 Drive chain disassembly**  
① Drive chain link

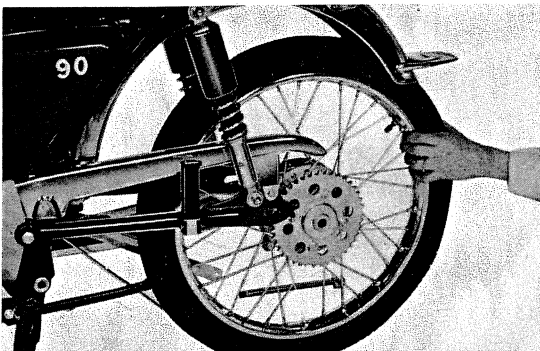

**Fig. 111 Rear wheel removal**

## A. Disassembly

- 1) Place an appropriate stand under the engine.
- 2) Remove the rear brake rod.
- 3) Unfasten the drive chain link and disconnect the chain.  
(Fig. 110)
- 4) Remove the rear brake arm bolt and then remove the rear brake arm from the brake panel.
- 5) Loosen the nut from the rear axle and remove the rear axle.
- 6) Remove the rear wheel. (Fig. 111)
- 7) Disassemble the brake panel from the wheel hub.  
Remove the brake arm from the panel, pull out the brake cam, disconnect the spring and then remove the brake shoes.
- 8) Straighten the tongued washer on the final driven sprocket, loosen the four mounting bolts, unfasten the circlips and then remove the final driven sprocket.