

## ASSEMBLY

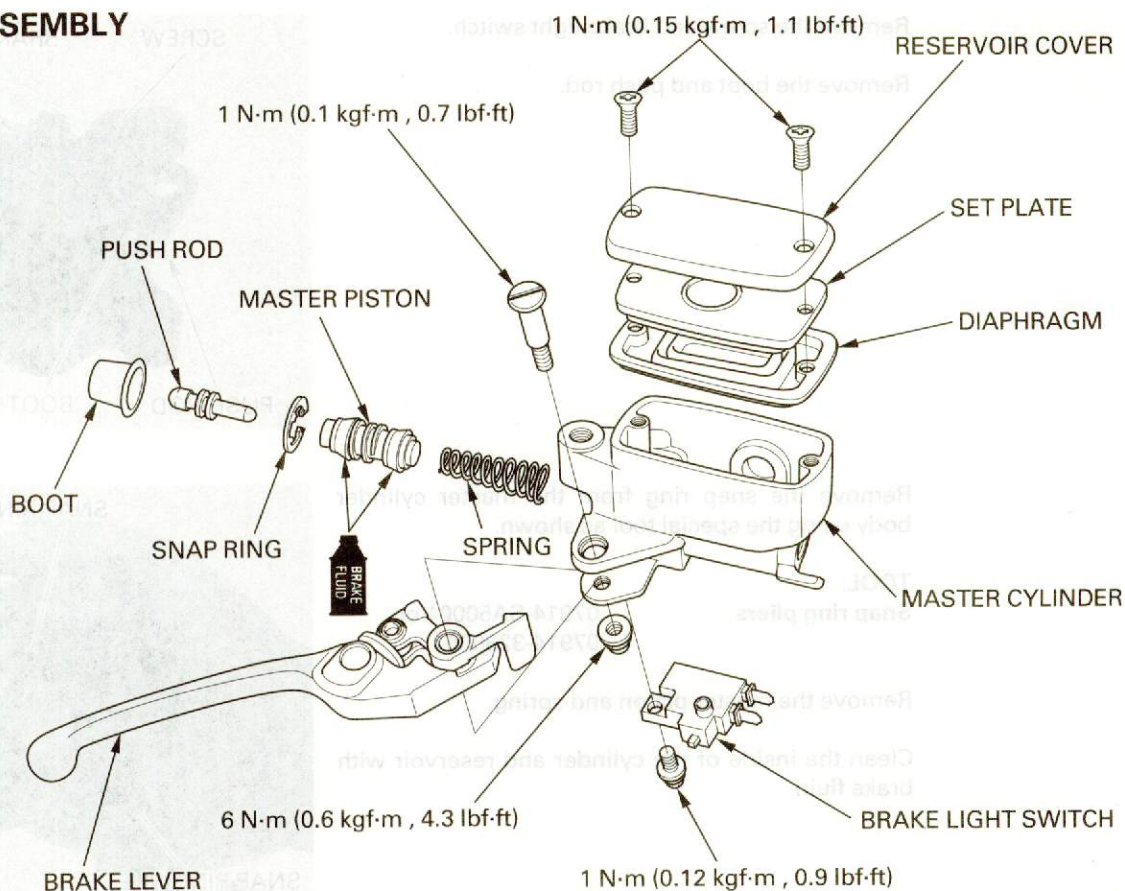

**CAUTION:**

*Keep the piston, cups, spring, snap ring and boot as a set; do not substitute individual parts.*

Coat all parts with clean brake fluid before assembly.  
 Dip the piston in brake fluid.  
 Install the spring to the piston.  
 Install the piston assembly into the master cylinder.

**CAUTION:**

*When installing the cups, do not allow the lips to turn inside out.*

Install the snap ring using the special tool.

**CAUTION:**

*Be certain the snap ring is firmly seated in the groove.*

**TOOL:**

Snap ring pliers

07914-SA50001 or  
 07914-3230001

