

4.12 FRONT WHEEL

A. Construction

The aluminum hub contains the brake assembly, front axle distance collar and bearing enclosed by the brake panel. The slot on the brake panel fits the cushion to prevent the panel from rotating.

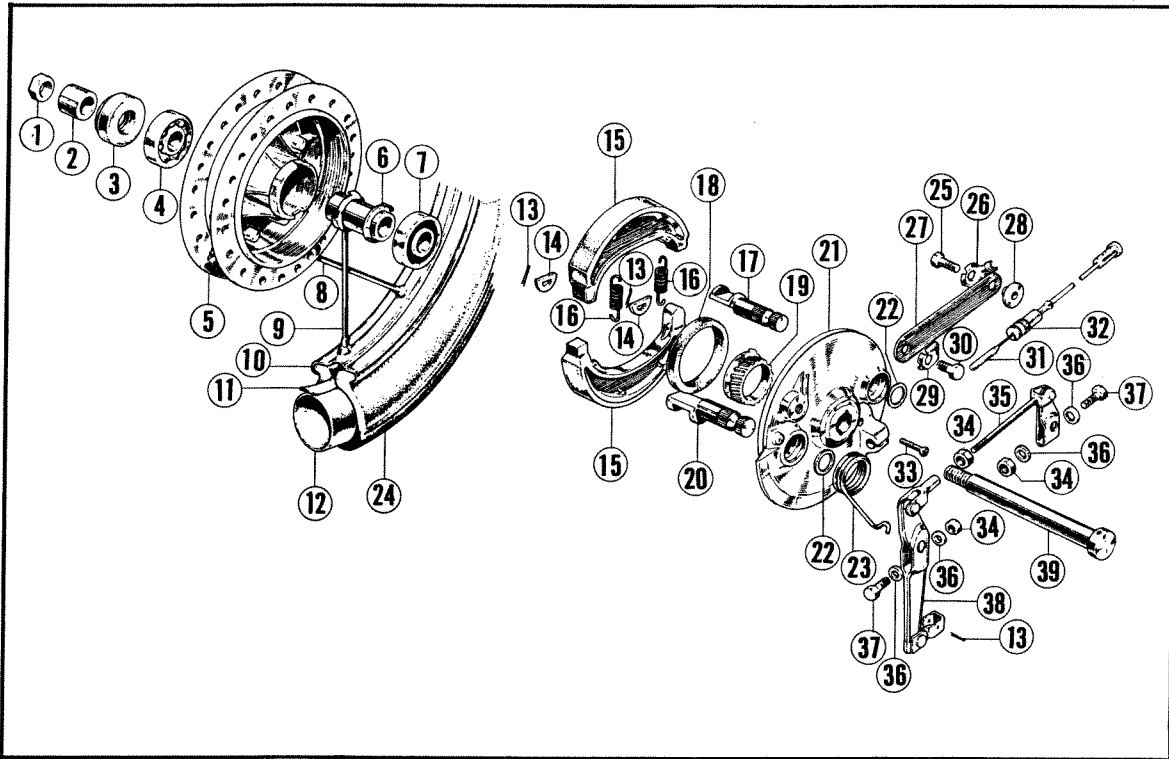

- ① Axle nut ② Front wheel side collar ③ 26427 oil seal ④ 6302 R ball bearing ⑤ Front wheel nub
 ⑥ Front axle distance collar ⑦ 6302 R ball bearing. ⑧ #9-157.5 spoke B. ⑨ #9-158 spoke B. ⑩ Front wheel rim
 ⑪ Tire flap ⑫ Front wheel tube ⑬ 2.0×18 cotter pin ⑭ Anchor pin washer ⑮ Front brake shoe
 ⑯ Front brake spring ⑰ Front brake cam ⑱ 54667 oil seal ⑲ Speedometer gear ⑳ Front brake cam
 ㉑ Front brake panel ㉒ Front brake cam dust seal ㉓ Front brake arm return spring ㉔ Front wheel tire
 ㉕ 8×28 hex. bolt. ㉖ 8.2mm tongued washer B. ㉗ Front brake stopper arm ㉘ Front brake stopper arm collar
 ㉙ 8.2mm tongued washer A ㉚ Front brake stopper arm bolt ㉛ Speedometer inner cable ㉜ Speedometer cable
 ㉝ 5×20 cross screw ㉞ 6mm hex nut ㉟ Front brake arm B ㊱ 6mm flat washer ㊲ 6×32 hex bolt
 ㊳ Front brake arm A ㊴ Front wheel axle

Fig. 4-52-1. Front wheel

B. Disassembly

1. Place a suitable support block under the engine to raise the front wheel off the ground.

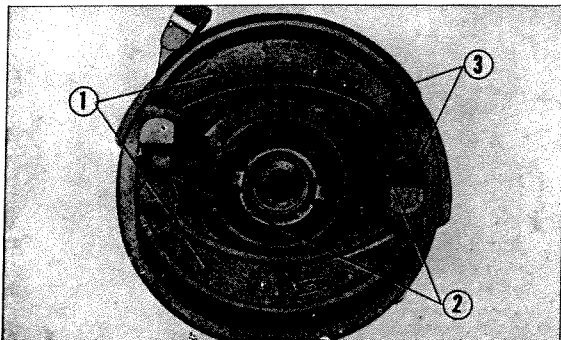

- ① Brake shoe ② 2.0×18 cotter pin
 ③ Anchor pin washer

Fig. 4-52-2. Removing the brake shoe

2. Disconnect the brake cable.
3. Remove the 5 mm screw and the speedometer cable from the gear box.
4. Straighten the tab of the 8.2 mm tongued washer A and loosen the front brake stopper arm bolt at the front brake stopper arm.
5. Loosen the front wheel axle nut and the wheel will drop off when the axle is drawn out.
6. Remove the panel from the front wheel, two 6302 R ball bearings, and the front axle distance collar.
7. Remove the two 2×18 cotter pins and anchor pin washer to remove the brake shoe from the panel. (Fig. 4-52-2)
8. Separate the tire and tube from the rim with a tire lever.