

3. With the gearshift drum in the neutral position, insert the guide pin into position and install the guide pin clip as shown in Fig. 4-91.

* The gearshift drum in the neutral position can be judged by the state of the points of the neutral switch.

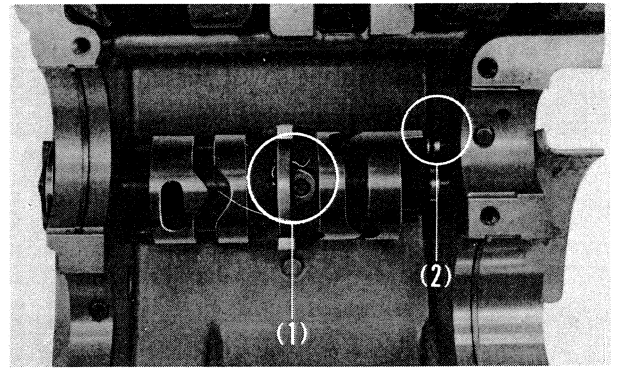

Fig. 4-91 (1) Installation direction of guide pin clip
(2) Neutral position

4. Install the gearshift forks A (the same parts) as shown at right and install the shift fork guide shaft.

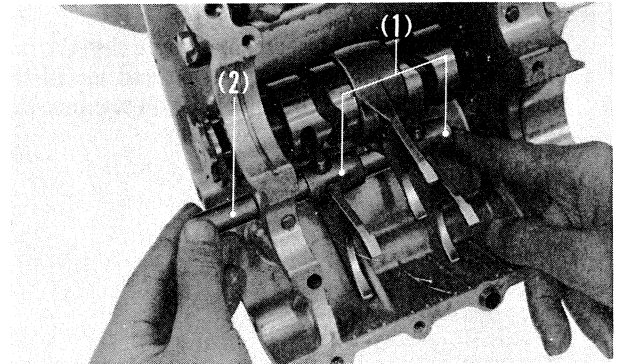
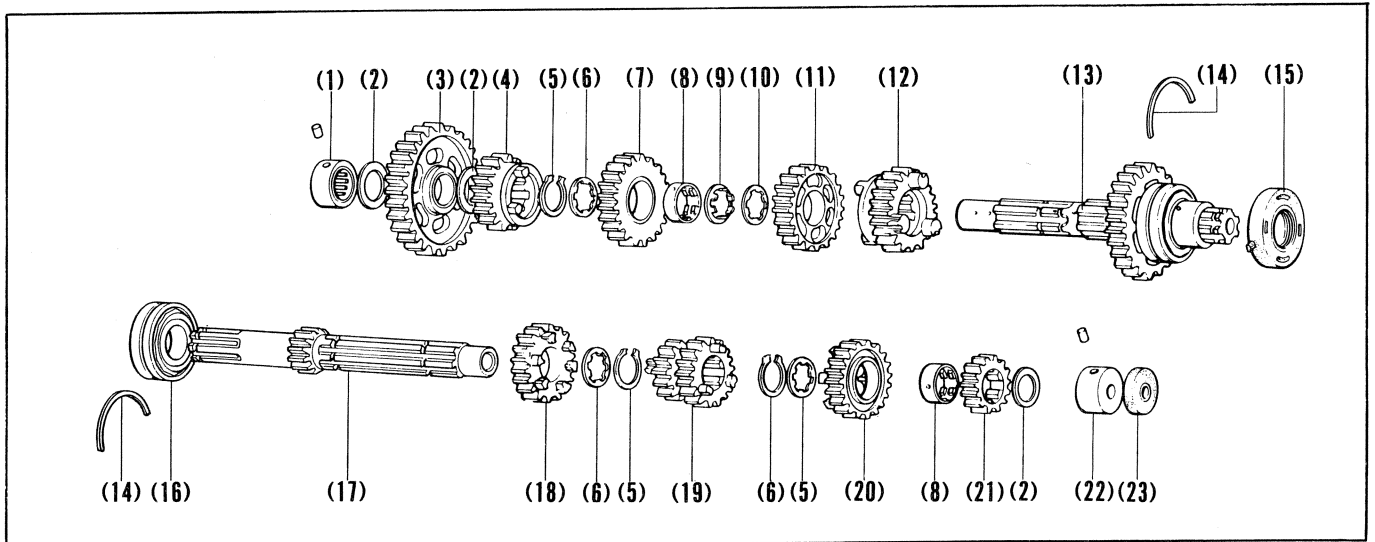

Fig. 4-92 (1) Gearshift fork A
(2) Gearshift fork guide shaft

5. Assemble the mainshaft and countershaft as shown in Fig. 4-93.

Replace any deformed snap ring with a new one.

Apply a coat of oil to the rotating and sliding surfaces.



<p>Fig. 4-93 (1) 20 mm needle bearing (2) 20 mm thrust washer (3) C-1st. gear (4) C-5th. gear (5) 25 mm snap ring (6) 25 mm thrust washer (7) C-3rd. gear (8) 28 mm splined bushing</p>	<p>(9) 25 mm lock washer (10) 25 mm thrust washer B (11) C-4th gear (12) C-6th gear (13) Transmission countershaft (14) 52 mm bearing set ring (15) 34x52x13.5x15.5 oil seal (16) 5205 HS ball bearing</p>	<p>(17) Transmission mainshaft (18) M-5th. gear (19) M-3rd. and 4th. gear (20) M-6th. gear (21) M-2nd. gear (22) 20 mm needle bearing (23) 8x34x8 oil seal</p>
---	--	--