

**Disassembly**

1. Remove the bolts (2) and remove the master cylinder.

**CAUTION:**

Take care not to spill brake fluid.

2. Disconnect the clutch cable.

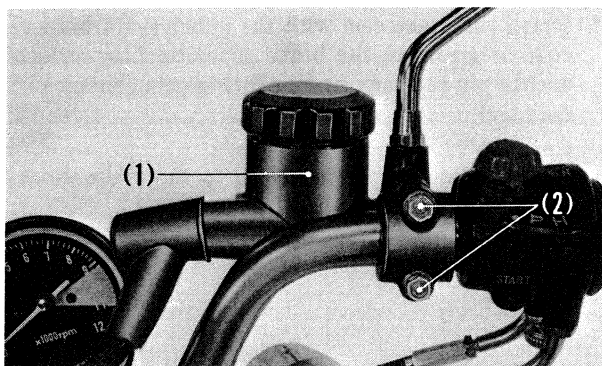

Fig. 5-48 (1) Master cylinder

3. Separate the starter/ignition switch into two parts. Disconnect the ends of the throttle cable wires from the throttle grip pipe and the throttle cables A and B from the starter/ignition switch.

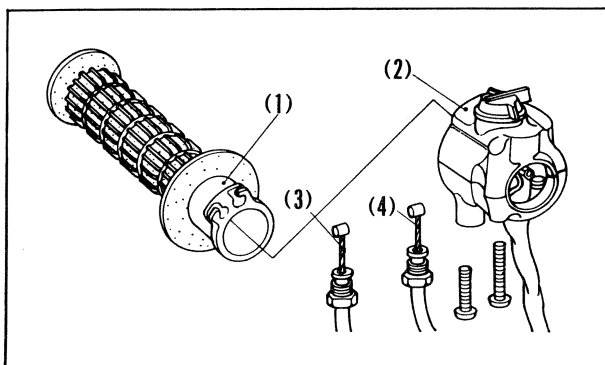

Fig. 5-49 (1) Throttle grip pipe  
(2) Headlight/ignition switch  
(3) Throttle cable A  
(4) Throttle cable B

4. Remove the fuel tank. Disconnect the horn/turn signal dimmer switch, headlight/ignition switch and clutch lever switch leads on the frame from the wire harness.
5. Remove the handlebar upper holders and remove the handlebar pipe.
6. Pull the horn/turn signal dimmer switch and headlight/ignition switch out of the handlebar pipe. Attach a wire to the end of each wire and remain the wire in the pipe to facilitate installation.

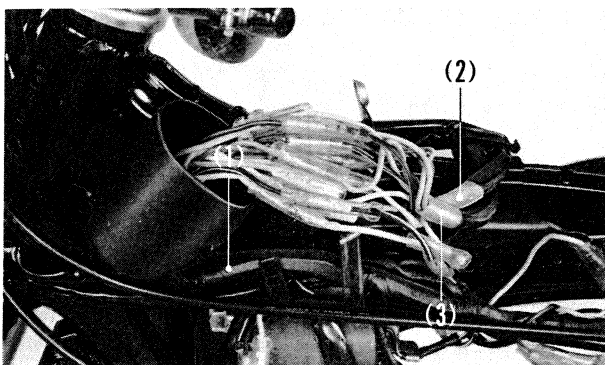

Fig. 5-50 (1) Wire harness  
(2) Horn/dimmer switch leads  
(3) Headlight/ignition switch leads

**Inspection**

1. Check the steering handlebar for warpage or breakage.
2. Check the wires for breakage or open circuit.
3. Check the cables for breakage.

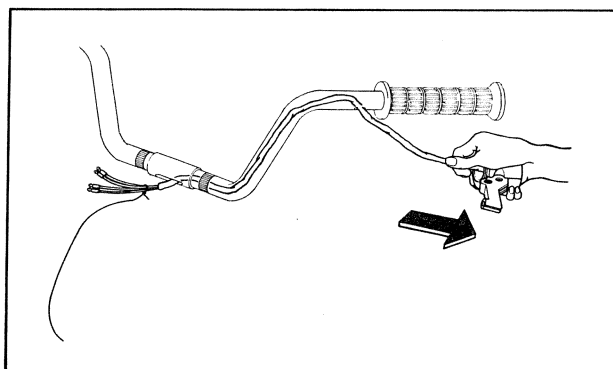

Fig. 5-51 Pulling switch lead