

CHANGE TO THE CENTER CRANKSHAFT JOURNAL FIT MARKINGS

Applicable production Models and Engine Serial Nos.:

CB250G5 CB250E-6011678 and subsequent
K5

CB360 CB350E-1055298 and subsequent
CB360G

CL360 CL360E-1012386 and subsequent

The fit markings of the center crankshaft journal have been changed as shown in the table below.

When replacing center crankshaft and center bearing assy, select the crankshaft and bearing with the same markings according to the right side table.

Select fit table of the center bearing
(radial clearance 12-20 μ)

Center crankshaft marking	Center bearing assy. marking
∪ or A	A
□ or B	B
∧ or C	C
≡ or D	D
ホ or E	E

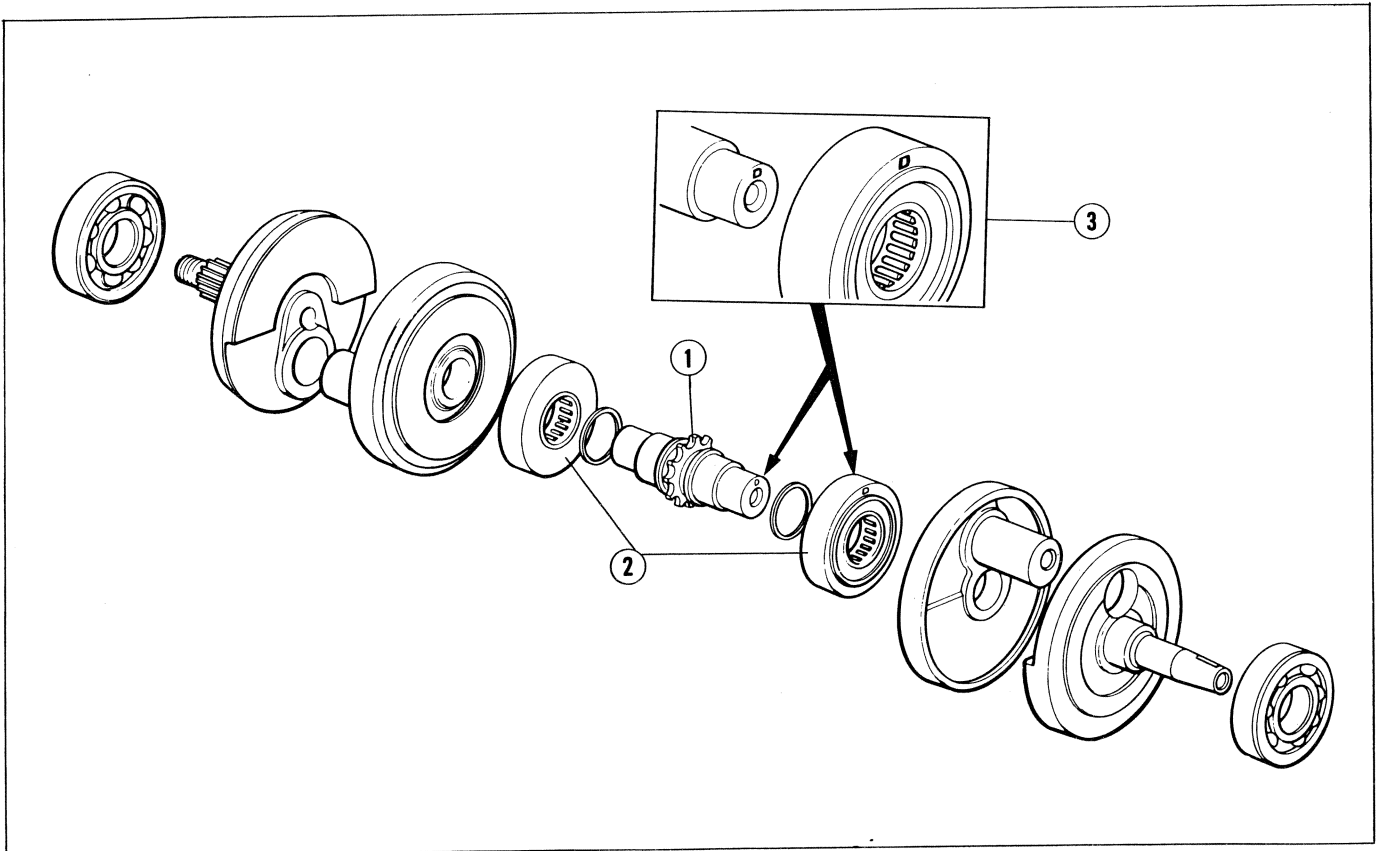

(1) Center crank
(2) Center bearing

(3) Marking position