

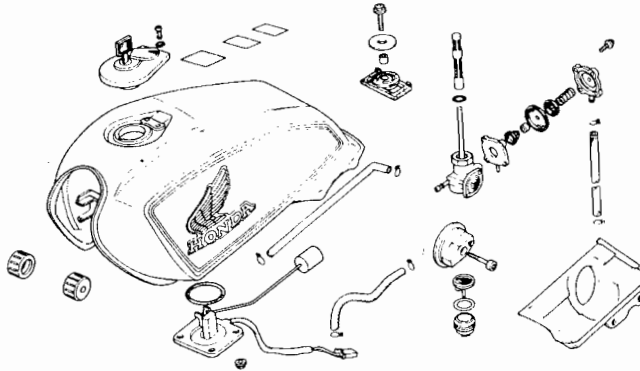

FUEL TANK INSTALLATION

Install the fuel tank in the reverse order of removal.
Make sure there are no fuel leaks after installation.



AIR CLEANER CASE

REMOVAL

Remove the seat and both frame side covers.

- Remove the rear wheel (Page 15-3).
- move rear fender A (Page 17-3).
- Remove the battery (Page 18-3).

Remove the tool box and regulator/rectifier by removing the bolts and disconnecting the couplers.

COUPLERS

TOOL BOX

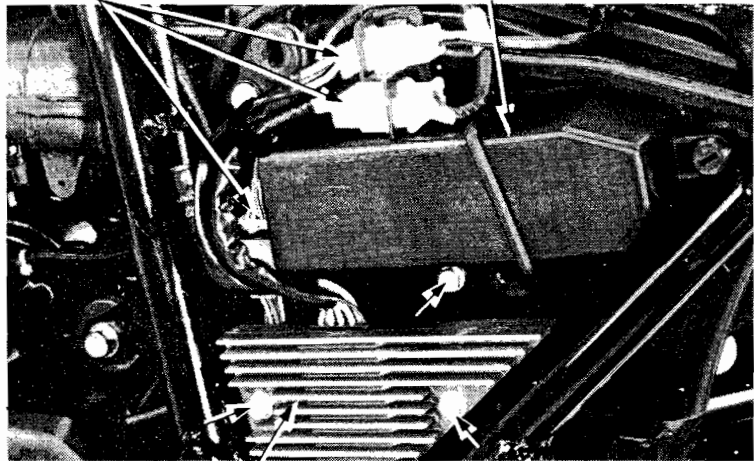

REGULATOR/RECTIFIER

Remove the starter and turn signal relays from the air cleaner case.

TURN SIGNAL RELAY



STARTER RELAY