

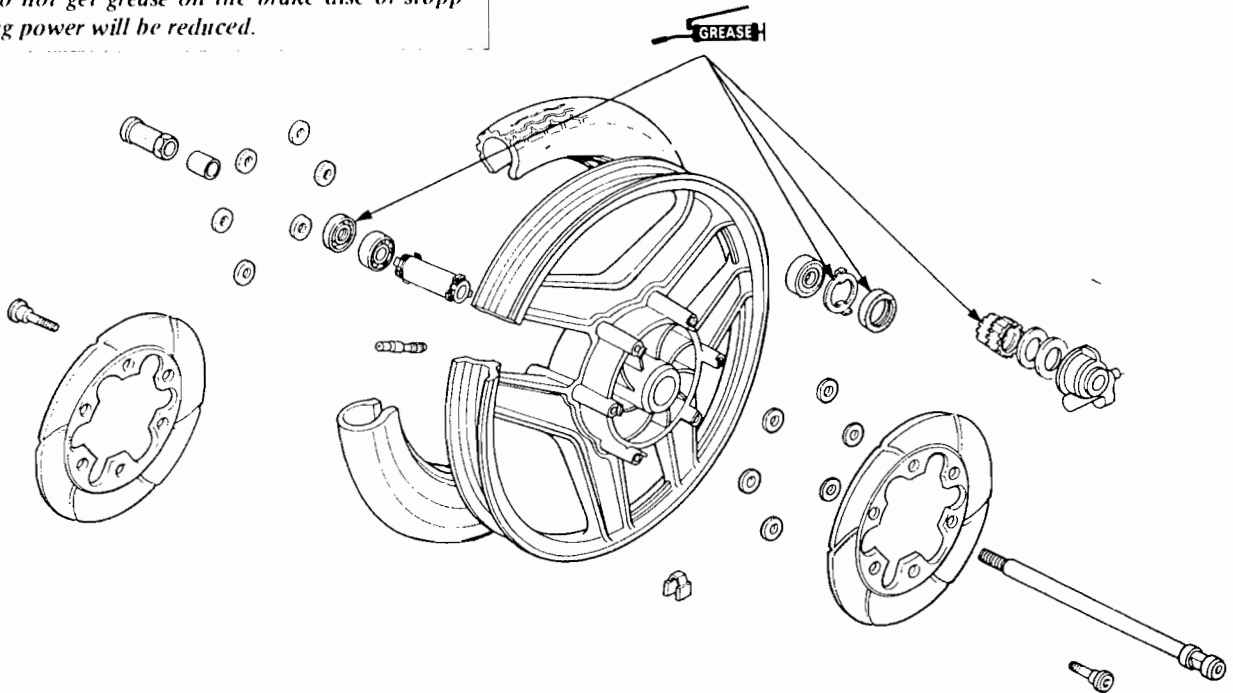

ASSEMBLY

WARNING

Do not get grease on the brake disc or stopping power will be reduced.



NOTE

- The cast wheel has no rim band.
- This motorcycle uses tubeless tires. For tubeless tire repair, refer to the Honda Tubeless Tire Manual.

Drive in the right bearing first and press the distance collar into place.

NOTE

Be certain the distance collar is in position before installing the left bearing.

Drive in the left bearing squarely.

NOTE

Drive the bearing into position, making sure that it is fully seated.

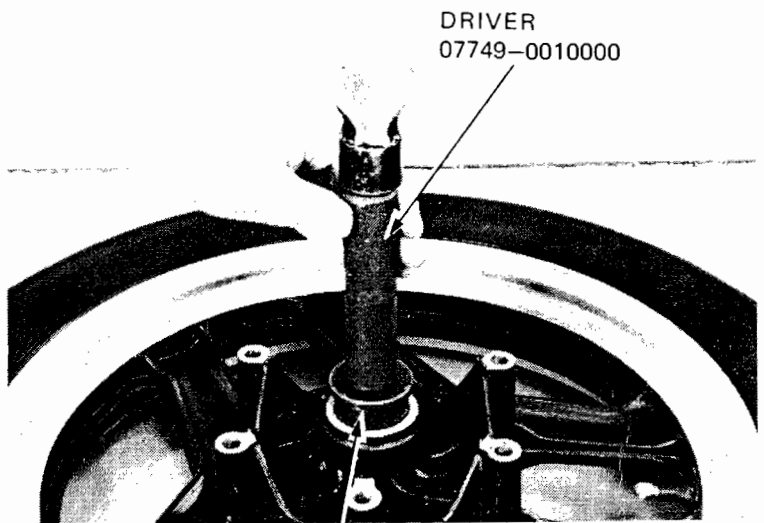

ATTACHMENT, 42 x 47 mm 07746-0010300
PILOT, 15 mm 07746-0040300