

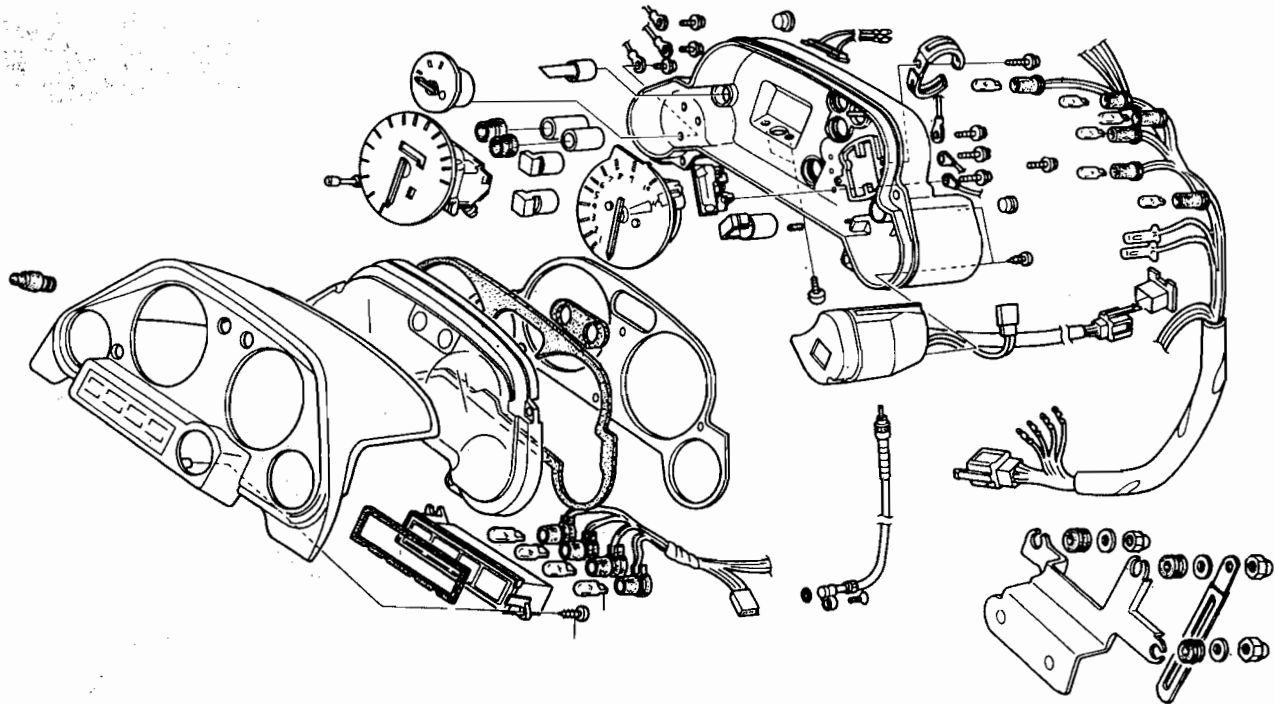

ASSEMBLY/INSTALLATION

Lubricate the speedometer cable before reconnecting.

Reassemble and install in the reverse order of removal and disassembly.



IGNITION SWITCH

Open the headlight case and disconnect the ignition switch coupler.

Check continuity between the color coded wires in the chart below.

Color code	R	R/Bk	Br/W	Br	Y/Bk
Terminal	BAT	IGN	TL1	TL2	P
ON	○	○	○	○	
OFF					
P	○				○
LOCK					

IGNITION SWITCH

