

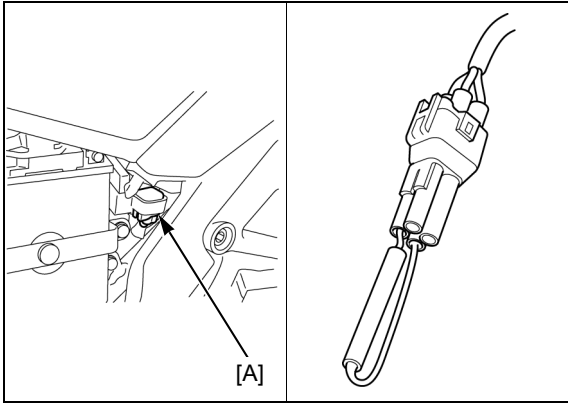

ECM INITIALIZATION PROCEDURE



- Make sure that DTC is not stored in ECM. If the DTC is stored in ECM, ECM initialization mode won't start by following the procedure below.



- Left side cover →3-4
- Connector cover from the DLC [A].
- Connect the special tool to the DLC.
SCS connector: 070PZ-ZY30100

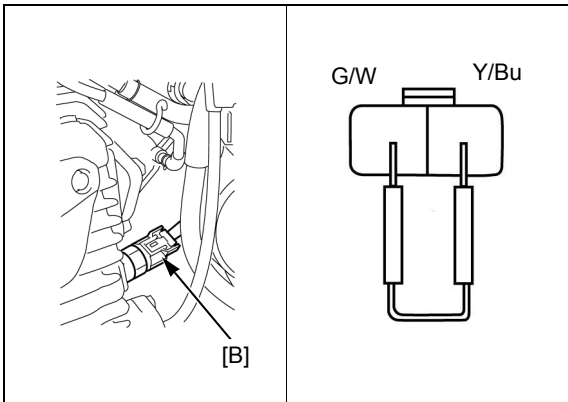

- EOT sensor 2P connector [B].
- Short the EOT sensor terminals with jumper wire.
Connection: Y/Bu – G/W

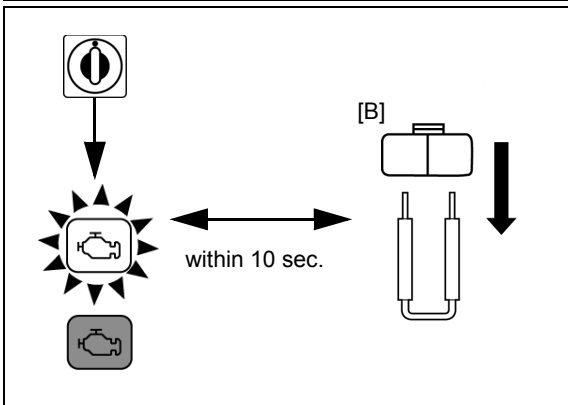

- Turn the ignition switch ON, and then disconnect the jumper wire from the EOT sensor 2P connector within 10 seconds while the MIL is blinking (initialization receiving pattern).
- Check for the MIL blinks.
After disconnecting the jumper wire, the MIL should start blinking. (initialization completed pattern)
If the jumper wire is connected for more than 10 seconds, the MIL will stay ON (unsuccessful pattern). Try again from the first.
- Check the engine idle speed.

