

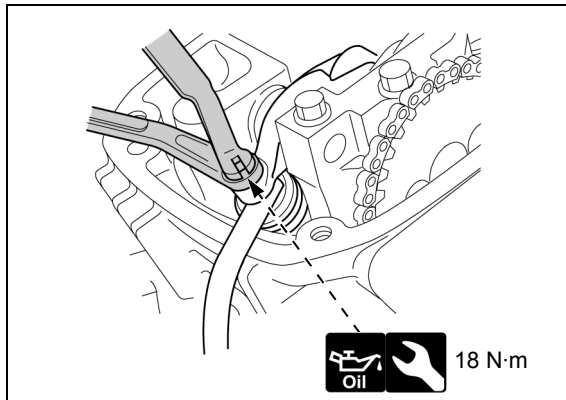

CYLINDER HEAD

- This service can be serviced with the engine installed in the frame.

VALVE CLEARANCE

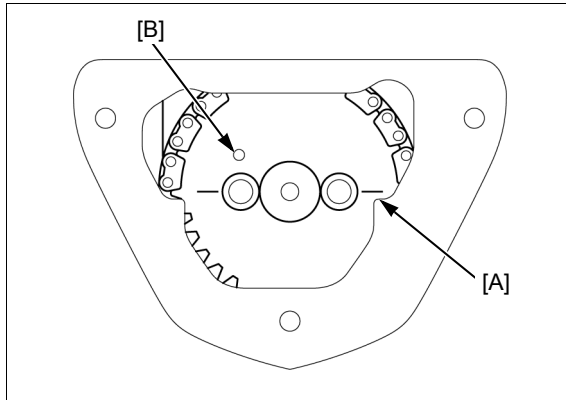
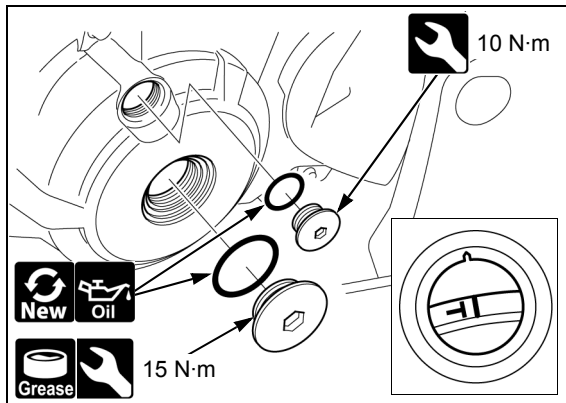

- Inspect while the engine is cold (below 35°C).
- After the valve clearance inspection, check the engine idle speed.
- Cylinder head cover →2-16



- Rotate the crankshaft counterclockwise and align the "T" mark on the flywheel with the index notch on the left crankcase cover.



- The index lines on the cam sprocket are align with the cylinder head tabs [A].
- Make sure that the mark [B] on the cam sprocket is in the position shown (TDC).
If the cam sprocket mark is not in position shown, rotate the crankshaft one full turn.



- Valve clearance (Insert a feeler gauge between the valve adjusting screw and valve stem).
IN: 0.08 ± 0.02 mm, EX: 0.24 ± 0.02 mm
Locknut wrench, 10 x 12 mm: 07708-0030200
Tappet adjusting wrench, 3 x 4 mm: 07908-KE90000
- Loosen the lock nut and turn the adjusting screw until there is a slight drag on the feeler gauge.
- Hold the adjusting screw and tighten the lock nut.
- Recheck the valve clearance after tightening.