

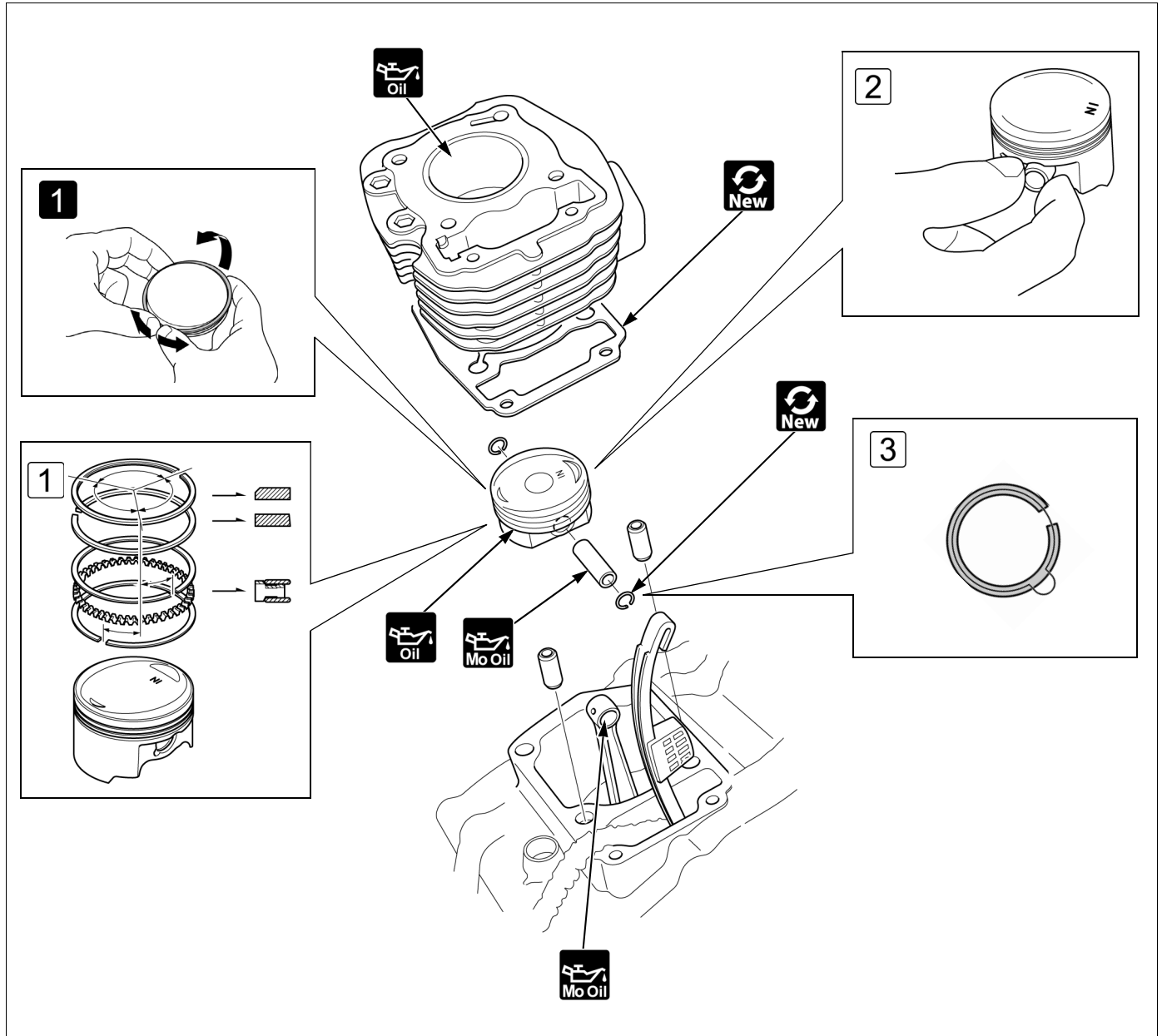









CYLINDER/PISTON

- This service can be serviced with the engine installed in the frame.

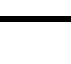

-  Cylinder head →2-15
-  Cam chain tensioner →2-20
-  1 Spread each piston ring and remove it by lifting up at a point opposite the gap.
-  1 Carefully install the piston rings into the piston ring grooves with the markings facing up.
 Top ring: "1R" or "TOP-1" mark
 Second ring: "RN" or "TOP-2" mark
-  2 Install the piston with the "IN" mark facing the intake side.
-  3 Do not align the piston pin clip end gap with the piston cut-out.
-  Piston and piston rings inspection
-  Cylinder inspection