

Set the brushes on the brush holder.
Install the brush holder onto the motor case.

Align the terminal holder plate boss with the groove of the motor case.

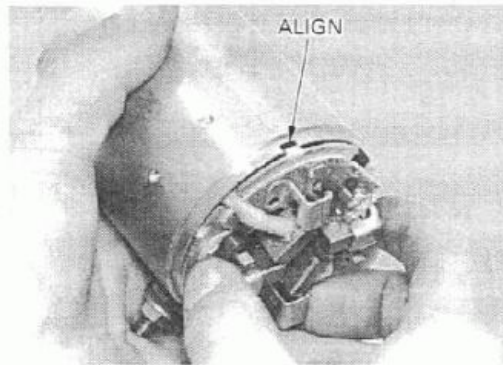

Install the following:

- O-ring
- Insulators
- Washer
- Nut

Install the insulators properly as noted during removal.

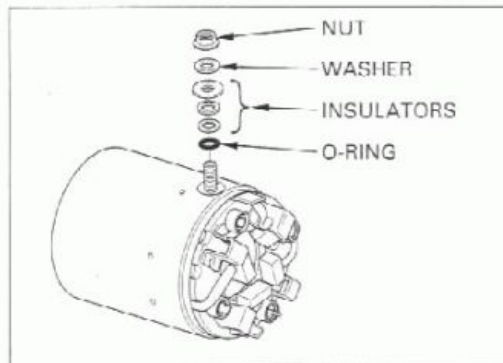

Install the armature in the motor case.

Install the shims on the armature shaft.

Install the insulated washer and lock washer on the armature shaft.

Install the seal ring onto the motor case.

Install the shims properly as noted during removal.

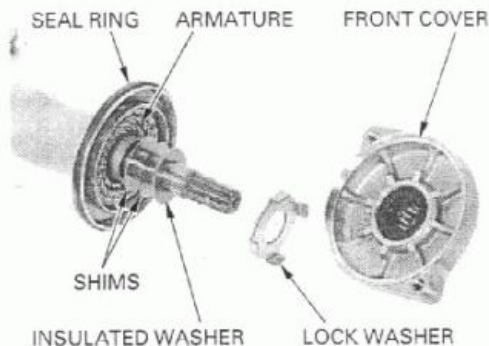

Install the seal ring on the motor case.
Install the shims on the armature shaft.

Assemble the motor case and rear cover, aligning the brush holder boss with the groove in the rear cover.

Install the shims properly as noted during removal.

