

INSTALLATION

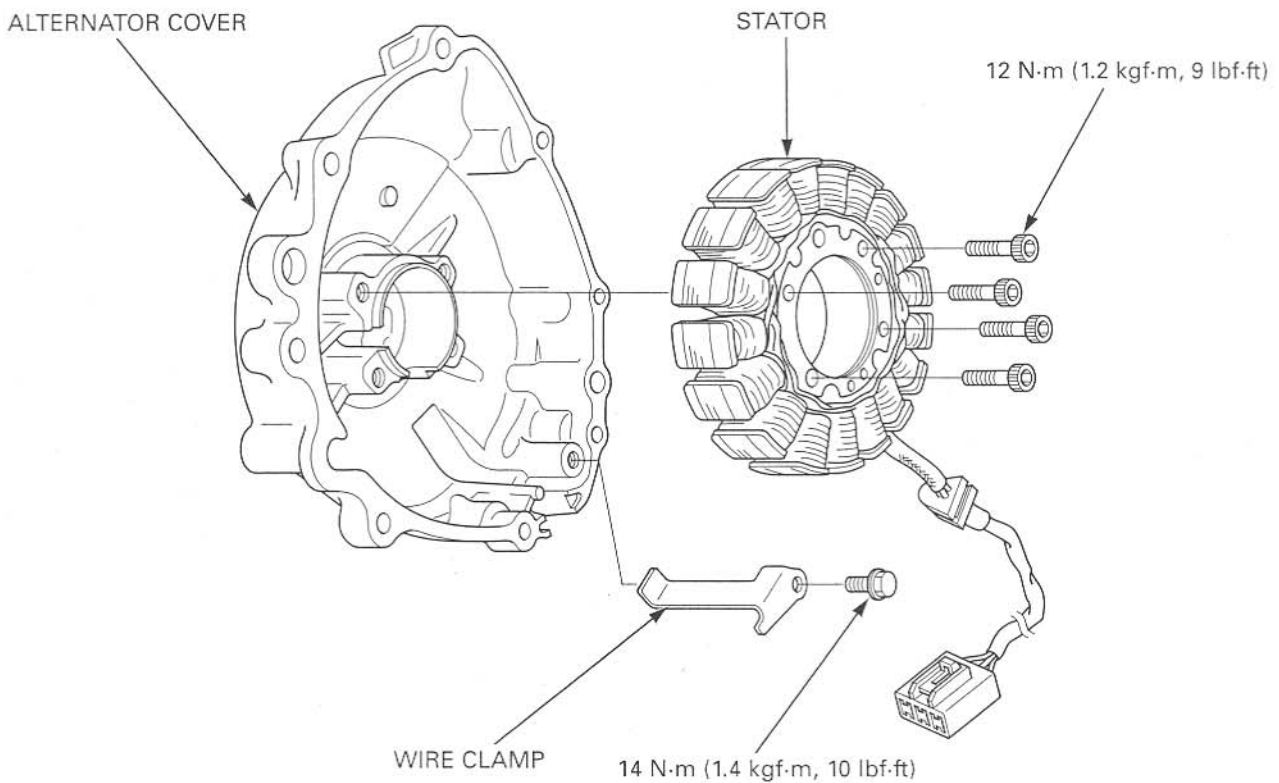

Install the stator into the alternator cover.

Apply sealant to the wire grommet, then install the wire grommet into the alternator cover groove securely.
Install and tighten the socket bolts to the specified torque.

TORQUE: 12 N-m (1.2 kgf-m, 9 lbf-ft)

Install the wire clamp and tighten the flange bolt to the specified torque.

TORQUE: 14 N-m (1.4 kgf-m, 10 lbf-ft)

Install the alternator cover (page 11-7).

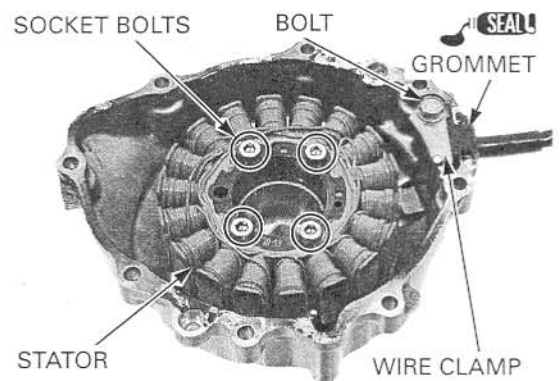

FLYWHEEL

REMOVAL

Remove the alternator cover (page 11-4).

Hold the flywheel using the special tool, then remove the flywheel bolt.

TOOL:

Flywheel holder

07725-0040000 or equivalent commercially available in U.S.A.

Remove the washer.

