

(1) DRIVER  
(2) ATTACHMENT

**Tools:**  
**Driver** 07749-0010000  
**Attachment, 42 x 47 mm** 07746-0010300

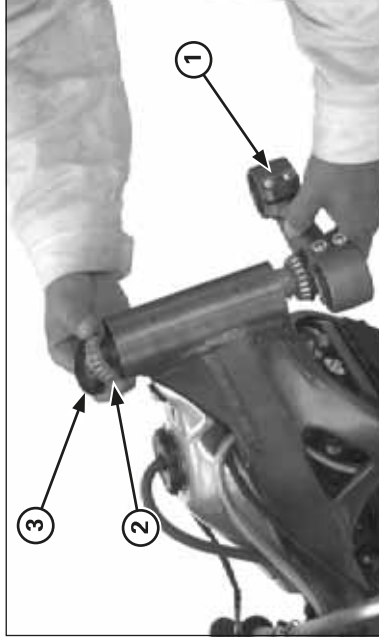

(1) STEM  
(2) UPPER BEARING  
(3) DUST SEAL

Install new bearing races.

Pack the upper and lower bearings with grease.  
Install the steering stem, upper bearing and dust seal.

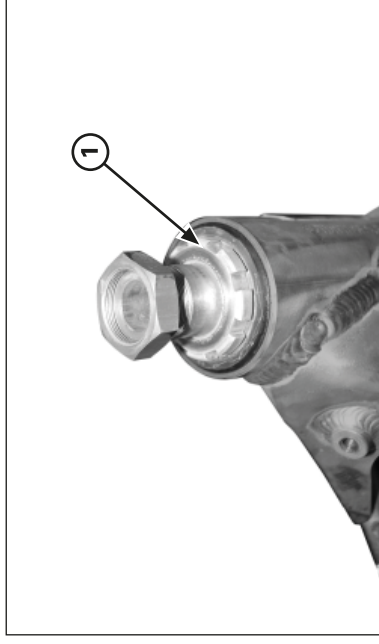

(1) ADJUSTING NUT

Screw the stem bearing adjusting nut all the way with your fingers.