

## Oil Pump Removal/Installation

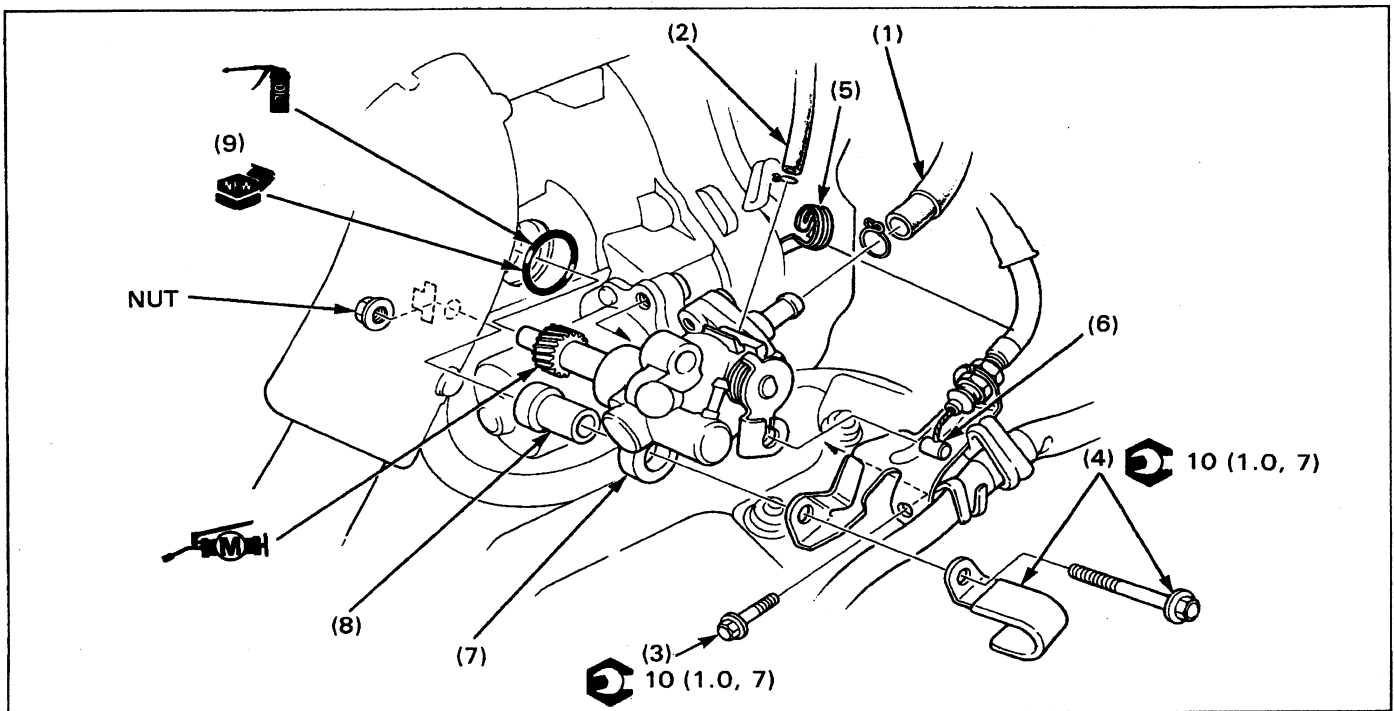

**NOTE**

- It is not necessary to loosen the oil pump adjusting nut. If the nut is loosened, perform the oil pump control cable adjustment (page 3-6) after installing the oil pump.
- After installing the oil pump, perform the oil pump/oil line bleeding referring to page 4-11 of the Common Service Manual.

**Requisite Service**

- Frame body cover removal/installation (page 2-3)

Procedure		Q'ty	Remarks
(1)	<b>Removal Order</b> Oil inlet tube	1	Installation is in the reverse order of removal. <b>NOTE</b> • Before disconnecting, clamp or plug the tube to prevent oil from flowing out.
(2)	Oil outlet tube	1	
(3)	Starter motor mounting bolt	1	<b>NOTE</b> • Be careful not to lose the nut at the oil pump side. Remove from oil pump control cable.
(4)	Oil pump mounting bolt/harness clamp	1/1	
(5)	Clamp	1	
(6)	Oil pump control cable	1	
(7)	Oil pump	1	
(8)	Oil pump mounting collar	1	
(9)	O-ring	1	