

Drive Pulley and Clutch/driven Pulley Removal/Installation

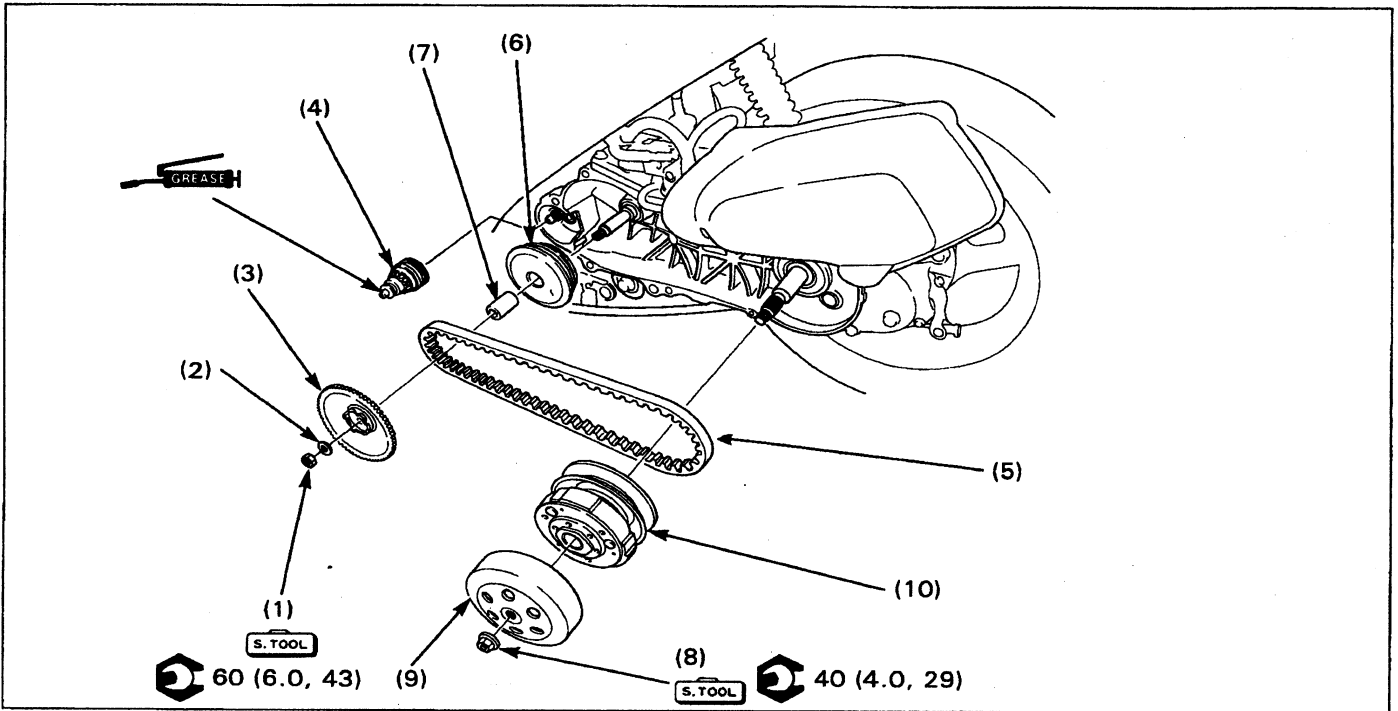

Requisite Service

- Left crankcase cover removal/installation (page 8-2)

Procedure	Q'ty	Remarks
Removal Order		Installation is in the reverse order of removal.
(1) Nut	1	
(2) Washer	1	
(3) Drive pulley face	1	Removal/installation (page 8-6)
(4) Starter pinion	1	
(5) Drive belt	1	
(6) Movable drive face	1	Disassembly/assembly (page 8-7)
(7) Movable drive face boss	1	
(8) Clutch outer nut	1	Removal/installation (page 8-6)
(9) Clutch outer	1	
(10) Clutch/driven pulley	1	Disassembly/assembly (page 8-8)