

## Steering Stem Removal/Installation

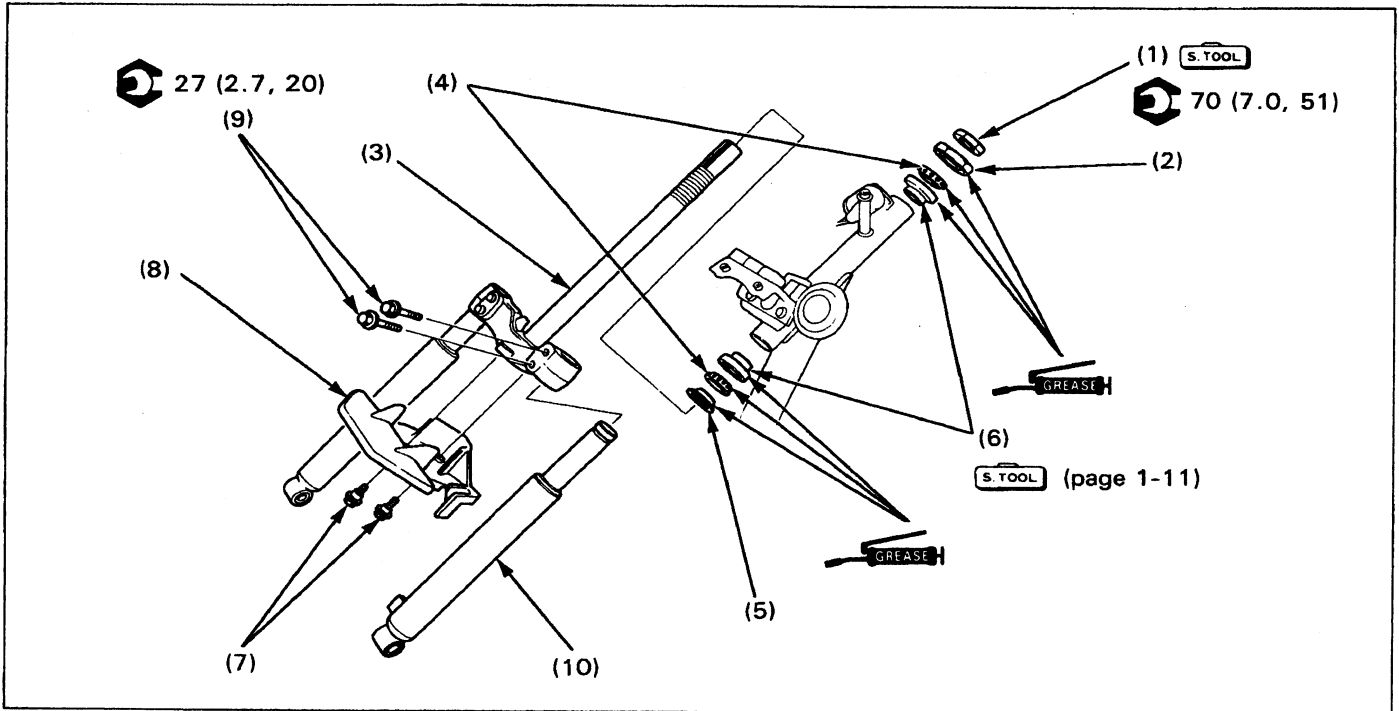

### Requisite Service

• Front wheel removal/installation (page 11-2)

• Handlebar removal/installation (page 11-6)

Procedure		Q'ty	Remarks
<b>Removal Order</b>			Installation is in the reverse order of removal. Installation (page 11-8)
(1)	Steering stem lock nut	1	
(2)	Top cone race	1	
(3)	Steering stem	1	
<b>Steering stem bearings/races</b>			
(4)	Steering stem bearing	2	
(5)	Bottom cone race	1	
(6)	Ball race	2	
<b>Front inner fender</b>			
(7)	Attaching bolt	2	
(8)	Front inner fender	1	
<b>Fork</b>			
(9)	Fork pinch bolt	4	NOTE • The upper pinch bolts are the locating bolts. Disassembly/Assembly (page 11-9)
(10)	Fork	2	