

# Starter Motor Removal/Installation

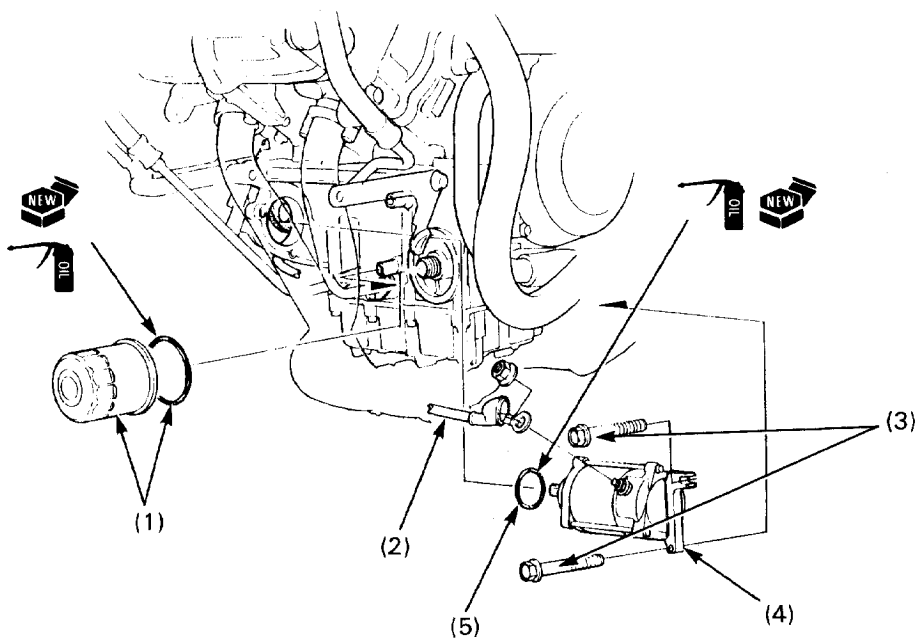

**⚠ WARNING**

- Turn the ignition switch OFF, remove the negative cable at the battery before servicing the starter motor.
- Do not service the starter motor while exhaust pipe is hot.

## Requisite Service

- Lower center fairing removal/installation (page 2-8).

Procedure		Q'ty	Remarks
(1)	<b>Removal Order</b> Oil filter/O-ring	1	• Installation is in the reverse order of removal. When installing, apply oil to the O-ring. Add the recommended engine oil to the upper level after installation (refer to Common Service Mannual, section 2).
(2)	Starter motor cable	1	
(3)	Starter motor mounting bolt	2	
(4)	Starter motor	1	Apply oil when installing.
(5)	O-ring	1	