

ASSEMBLY

CAUTION:

*Handle the master piston, spring, primary cup and secondary cup as a set.*

Coat all parts with clean brake fluid before assembly.

Install the spring, primary cup and piston.

CAUTION:

*When installing the cups, do not allow the lips to turn inside out.*

Install the circlip making sure it is seated firmly in the groove. Then install the boot and push rod. Install the clutch switch, if it was removed.

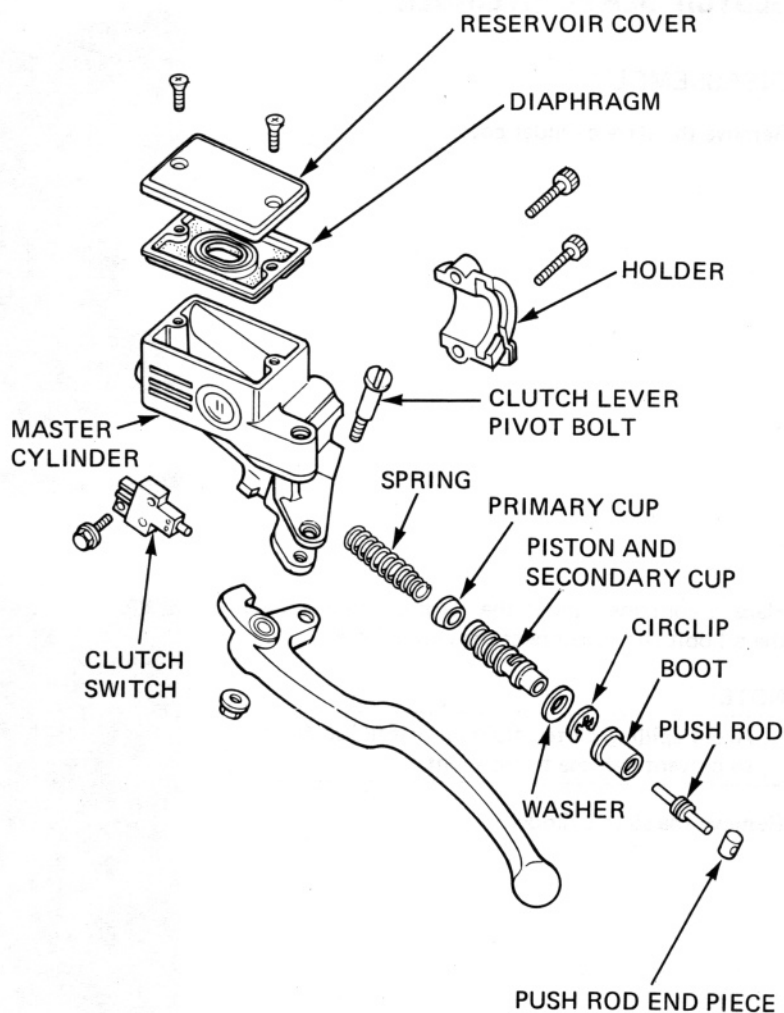

Place the master cylinder on the handlebar and install the holder and the two mounting bolts. Align the end of the holder with the handlebar punch mark. Tighten the top bolt first, then the bottom bolt.

Install the oil hose with the bolt and its two sealing washers.

Install the push rod end piece into the clutch lever hole and install the clutch lever.

Connect the clutch switch wires to the switch terminals. Fill the reservoir and bleed the clutch system (page 7-4).

