

FRONT WHEEL/SUSPENSION/STEERING

INSTALLATION

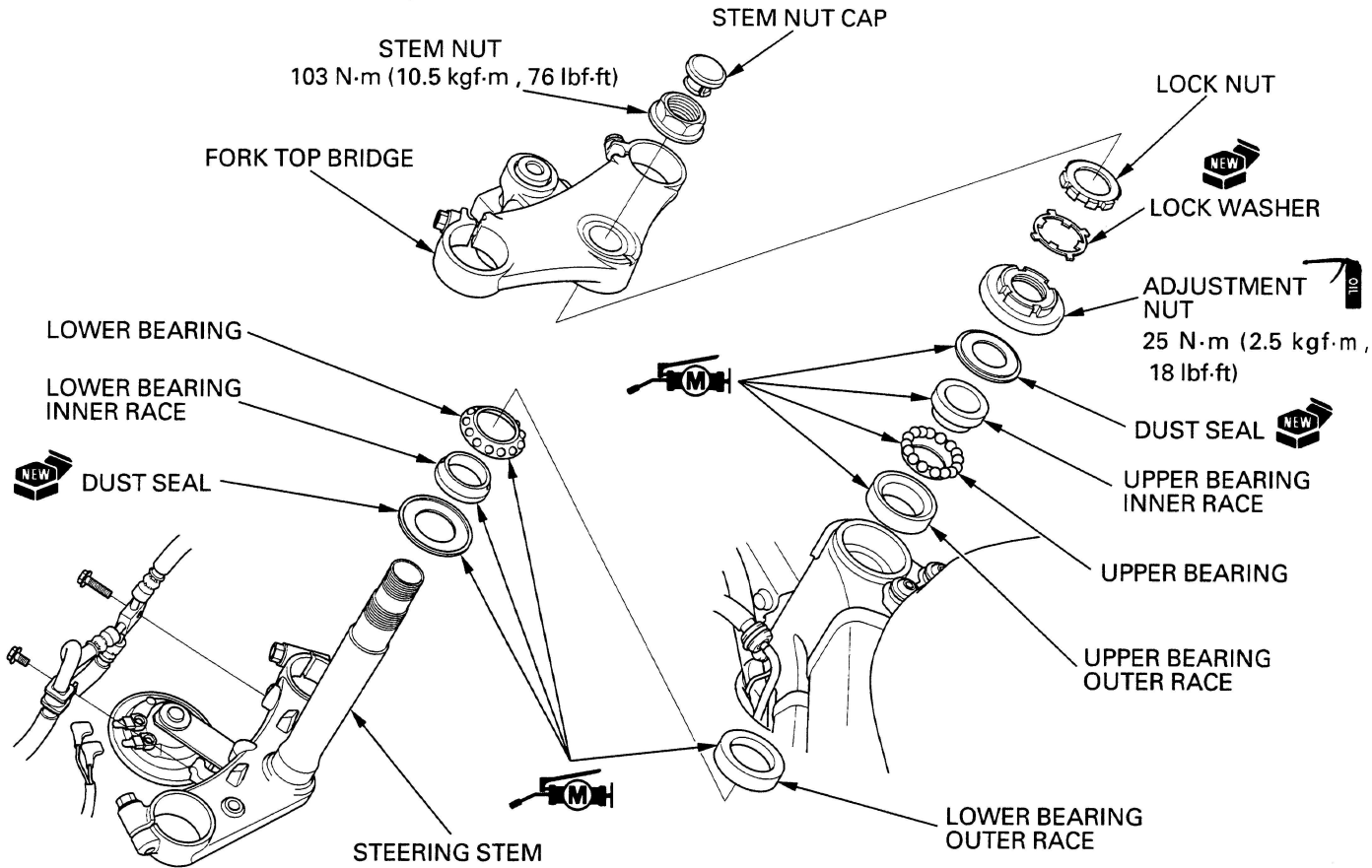

Apply molybdenum disulfide grease to the steering bearings and bearing races.
Install the lower bearing onto the steering stem.
Install the steering stem into the steering head pipe.
Install the upper bearing and inner race.

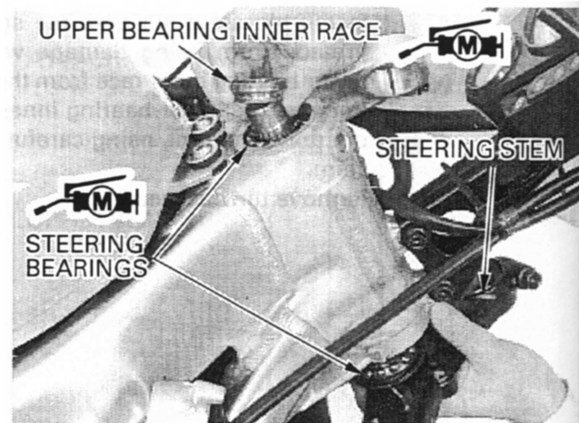

Apply molybdenum disulfide grease to a new dust seal and install it.

