

### SIDE SHROUD

#### REMOVAL/INSTALLATION

Remove the side cover (page 2-2).

Remove the screw [1] and bolts [2].

Remove the side shroud [3] while releasing its hole from the hook [4] on the fuel tank.

Installation is in the reverse order of removal.

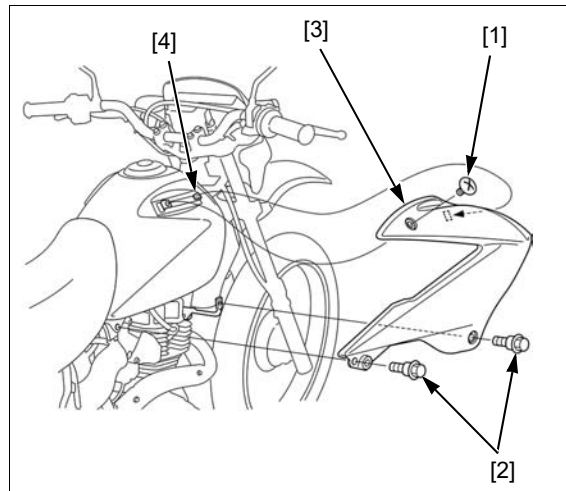

### FUEL TANK

#### REMOVAL/INSTALLATION

Remove the following:

- Side covers (page 2-2)
- Seat (page 2-2)
- Side shrouds (page 2-4)

Turn the fuel valve "OFF".

Disconnect the fuel hose from the fuel valve.

Remove the bolt [1], collar [2] and mount rubber [3].

Remove the fuel tank [4] while releasing it from the rubber mounts [5].

Installation is in the reverse order of removal.

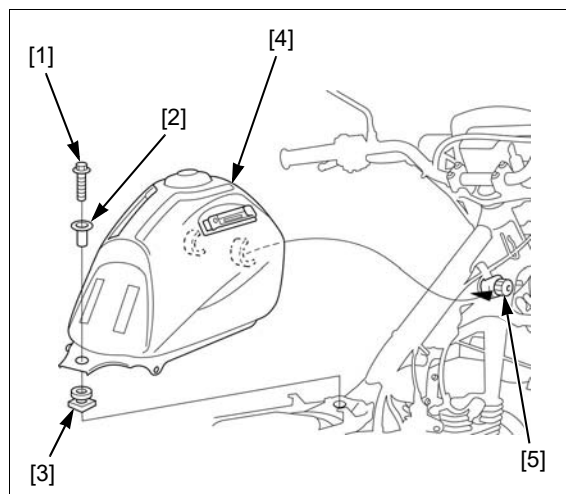

### FRONT VISOR

#### REMOVAL/INSTALLATION

Remove the following:

- Two bolts [1]/setting nuts [2]
- Headlight aim adjusting screw [3]/washer [4]
- Mount rubber [5]
- Collar [6]
- Nut [7]
- Headlight aim adjuster [8]

Disconnect the headlight connector [9] from the front visor [10].

Installation is in the reverse order of removal.

After installation, adjust the headlight aim (page 3-15).

