

## MAINTENANCE

### ENGINE OIL CENTRIFUGAL FILTER

Remove the right crankcase cover (page 10-4).

Remove the following:

- Screws [1]
- Oil filter rotor cover [2]
- Gasket [3]

Clean the oil filter rotor cover and inside of the oil filter rotor using a clean lint-free cloth.

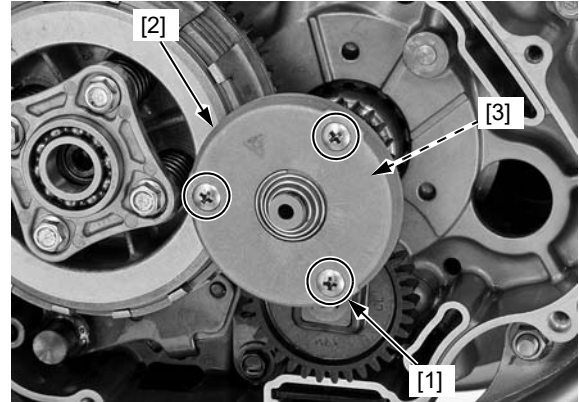

Remove the clip [1] while holding the oil through [2].  
Remove the oil through and spring [3].

Blow compressed air through the oil through hole and the rotor cover [4] to clean them.

Apply engine oil to the oil through sliding area.  
Install the spring and oil through, and secure it with the clip.

Check that the oil through operates freely, without binding.

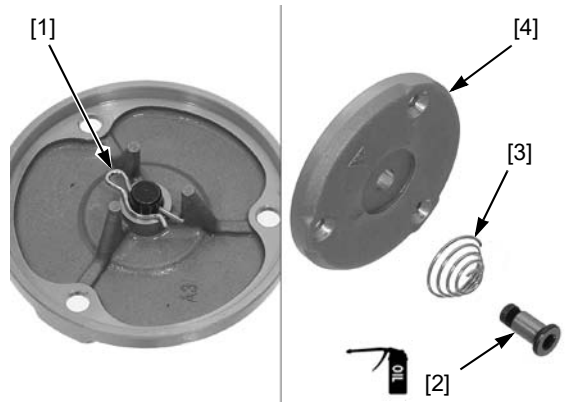

Install the rotor cover [1] with a new gasket [2] and tighten the three screws.

**TORQUE: 4.0 N·m (0.4 kgf·m, 3.0 lbf·ft)**

Install the right crankcase cover (page 10-4).

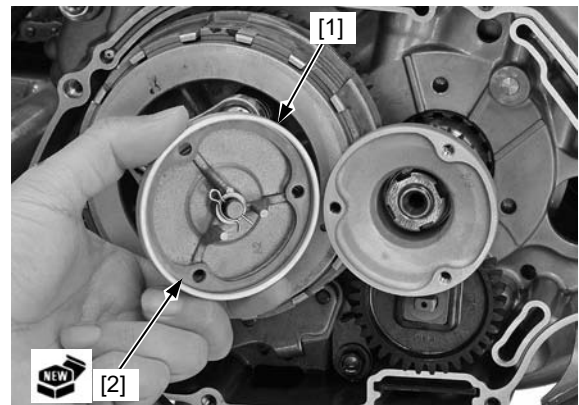

### ENGINE IDLE SPEED

- Inspect and adjust the idle speed after all other engine maintenance items have been performed and are within specifications.
- Engine must be warm for accurate adjustment. Ten minutes of stop-and-go riding is sufficient.

Warm the engine, shift the transmission into neutral and support the motorcycle upright on a level surface.

Connect a tachometer and check the idle speed.

**IDLE SPEED: 1,500 ± 100 min<sup>-1</sup> (rpm)**

If the adjustment is necessary, turn the throttle stop screw [1] as required.

