

## SECONDARY AIR SUPPLY SYSTEM (XR125LK/LEK)

- The secondary air supply system introduces filtered air into exhaust gases in the exhaust port. The secondary air is drawn into the exhaust port whenever there is negative pressure pulse in the exhaust system. This charged secondary air promotes burning of the unburned exhaust gases and changes a considerable amount of hydrocarbons and carbon monoxide into relatively harmless carbon dioxide and water.

*If the hoses show any signs of heat damage, inspect the PAIR check valve in the PAIR reed valve cover for damage.*

Check the PAIR (pulse secondary air injection) hoses between the air cleaner sub filter [1], PAIR control valve [2] and cylinder head cover for deterioration, damage or loose connections. Make sure that the hoses are not cracked.

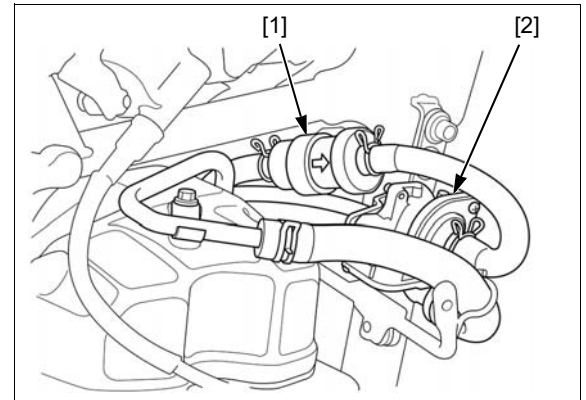

Check the PAIR hoses [1] between the air cleaner sub filter and air inlet cover for deterioration, damage or loose connections. Make sure that the hoses are not kinked, pinched or cracked.

Check the vacuum hose [2] between the PAIR control valve and carburetor insulator for deterioration, damage or loose connections. Make sure that the hoses are not kinked, pinched or cracked.

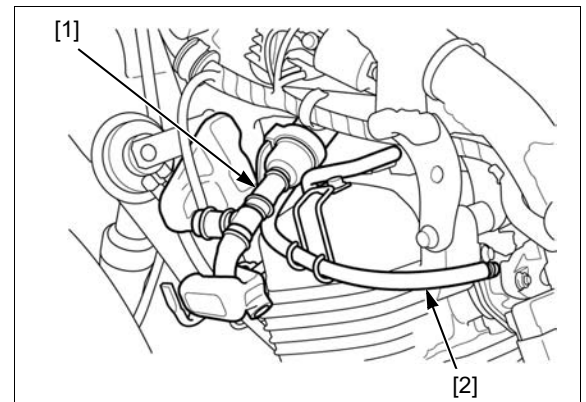

## DRIVE CHAIN

### DRIVE CHAIN SLACK INSPECTION

Turn off the engine, support the motorcycle on its sidestand and shift the transmission into neutral.

Check the slack in the drive chain lower run midway between the sprockets.

**CHAIN SLACK: 20 – 30 mm (0.8 – 1.2 in)**

