

LUBRICATION SYSTEM

DISASSEMBLY/ASSEMBLY

Disassemble and assemble the oil pump as following illustration.

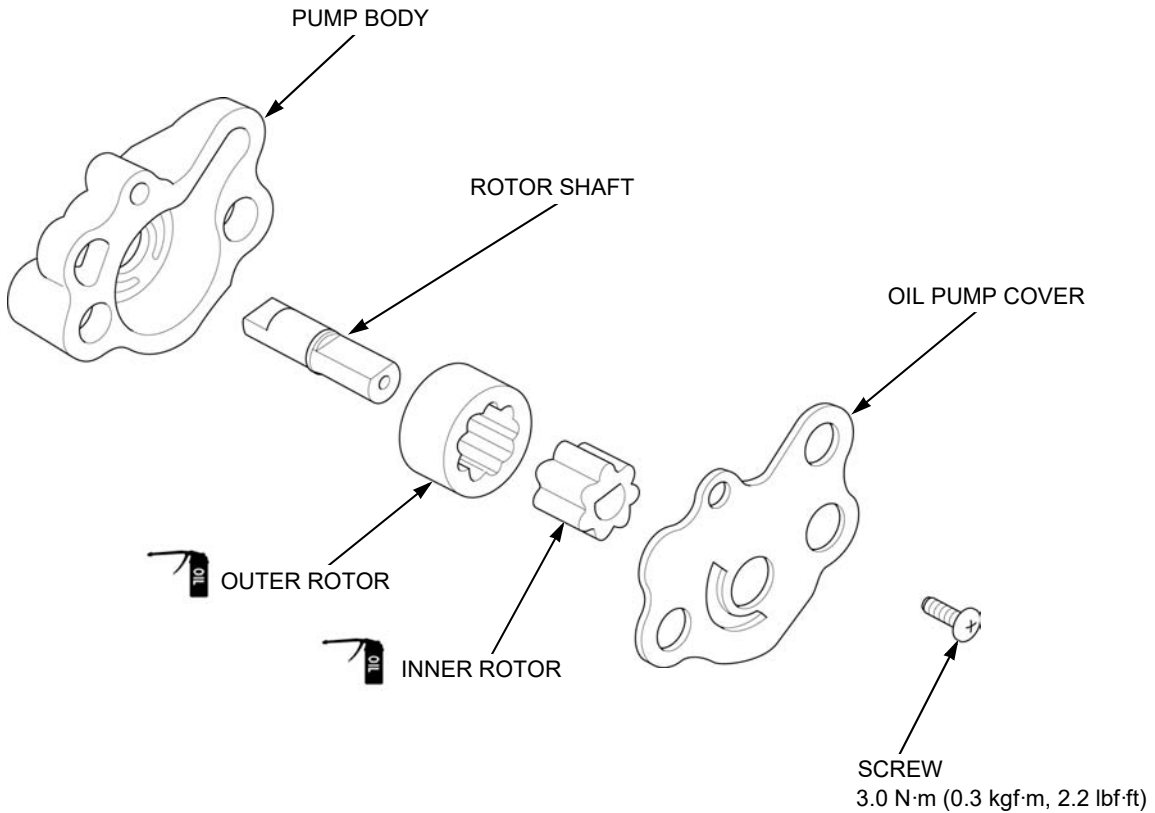

INSPECTION

Disassemble the oil pump (page 7-4).

- Measure at several places and use the largest reading to compare to the service limit.
- If any portion of the oil pump is worn beyond the specified service limit, replace the oil pump and pump cover as an assembly.

Temporarily install the outer rotor, inner rotor and oil pump shaft into the oil pump body.

TIP CLEARANCE

Measure the tip clearance.

SERVICE LIMIT: 0.20 mm (0.008 in)

BODY CLEARANCE

Measure the body clearance.

SERVICE LIMIT: 0.25 mm (0.010 in)

SIDE CLEARANCE

Remove the oil pump shaft.

Measure the side clearance using a straight edge and feeler gauge.

SERVICE LIMIT: 0.12 mm (0.005 in)

Assemble the oil pump (page 7-4).

