

CAM CHAIN TENSIONER LIFTER

REMOVAL/INSTALLATION

Remove the sealing plug [1] and O-ring [2] from the cam chain tensioner lifter.

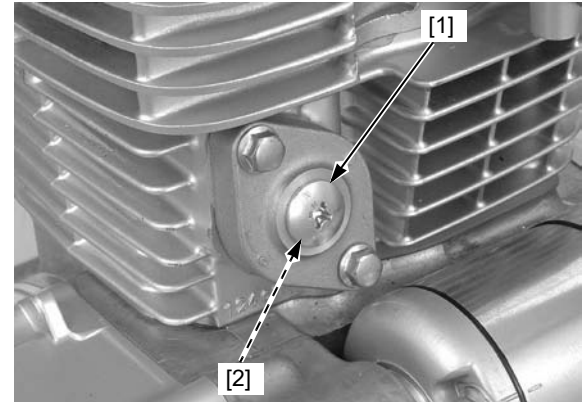

Turn the cam chain tensioner lifter shaft [1] clockwise fully and secure it using the special tool.

TOOL:

[2] Tensioner stopper 070MG-0010100

Remove the two mounting bolts [3].

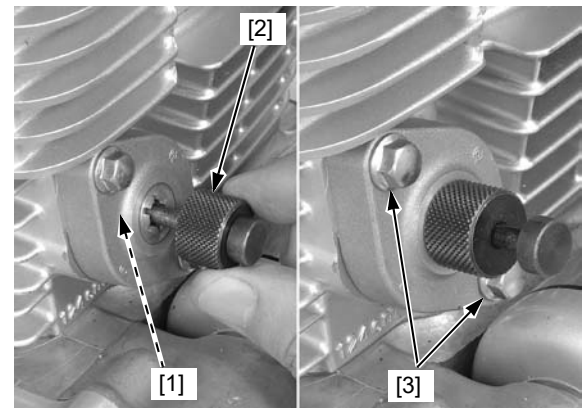

Remove the cam chain tensioner lifter [1] and gasket [2] from the cylinder.

Remove the tensioner stopper from the tensioner lifter.

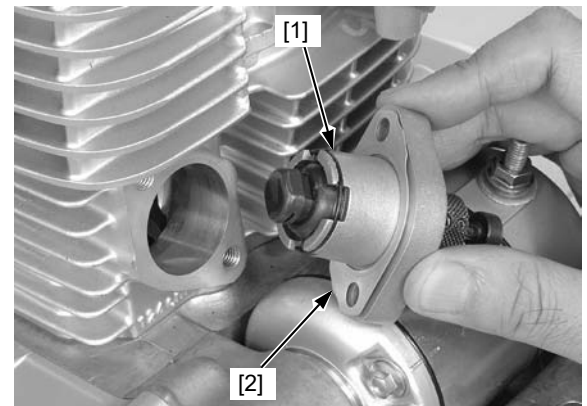

Check the cam chain tensioner lifter operation:

- The tensioner lifter shaft should not go into the body when it is pushed.
- When it is turned clockwise with a screwdriver, the tensioner lifter shaft should be pulled into the body. The shaft should spring out of the body as soon as the screwdriver is released.

Turn the cam chain tensioner lifter shaft clockwise fully and secure it using the special tool.

TOOL:

[1] Tensioner stopper 070MG-0010100

