

ENGINE REMOVAL/INSTALLATION

SYSTEM COMPONENTS

XR125LK/LEK shown:

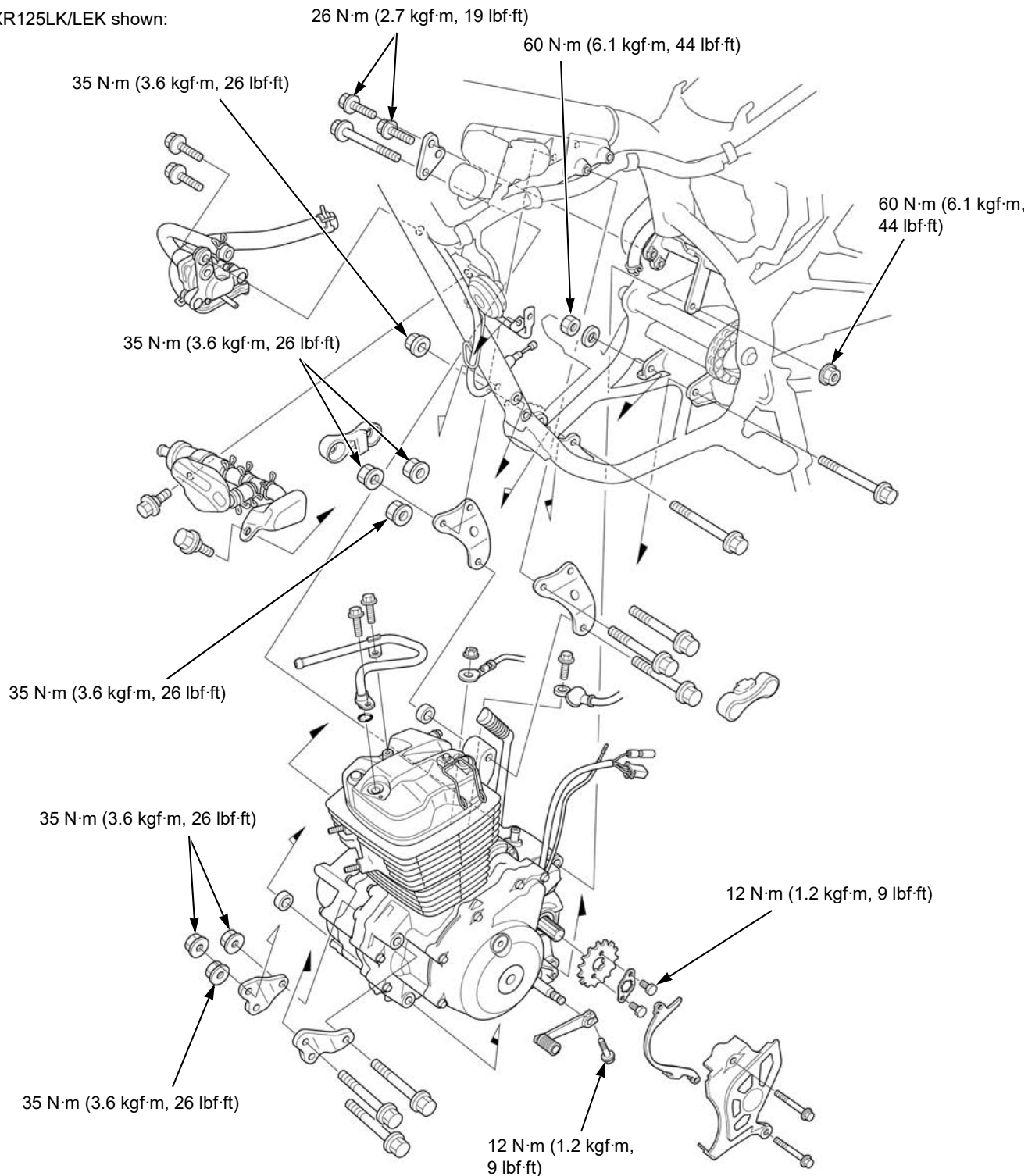

SERVICE INFORMATION

GENERAL

- A floor jack or other adjustable support is required to support and maneuver the engine.
- When removing/installing the engine, tape the frame around the engine beforehand for frame protection.
- The following components require engine removal for service.
 - Crankshaft (page 12-13)
 - Transmission (page 12-8)