

## ENGINE REMOVAL/INSTALLATION

Disconnect the following:

- Alternator 2P connector [1]
- Ignition pulse generator wire connector [2]
- Neutral switch wire connector [3]



- Starter motor cable [1] (by removing the rubber cap [2] and terminal nut [3])
- Battery negative cable [4] (by removing the motor mounting bolt [5])

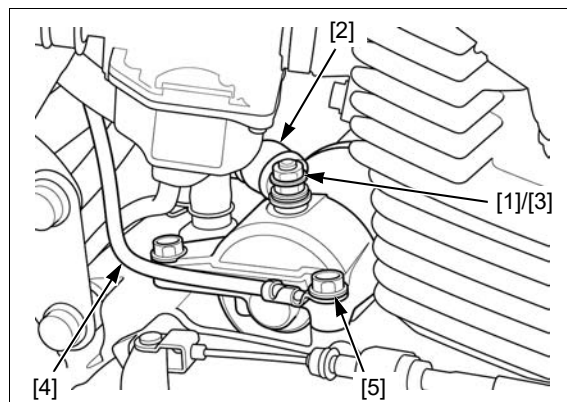

Remove the rubber caps [1] from the upper engine hanger plates.

Remove each engine hanger plate, hanger bolt and nut.

- Two upper engine hanger plate nuts [2], bolts [3]
- Upper engine hanger nut [4] and bolt [5]
- Hanger plates [6] and collar [7]

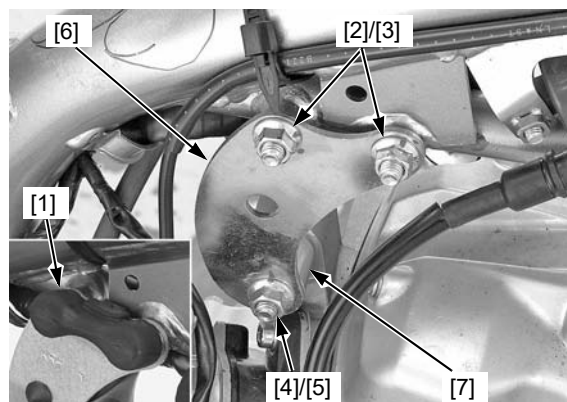

- Rear upper engine hanger nut [1] and bolt [2]
- Rear upper engine hanger plate bolts [3]
- Hanger plate [4]
- Crankcase breather hose [5]

