



**CLUTCH/OIL PUMP**

**OIL PUMP DISASSEMBLY**

Remove the oil pump body screws, and the pump gear and cover.

Remove the inner and outer rotors from the pump body.

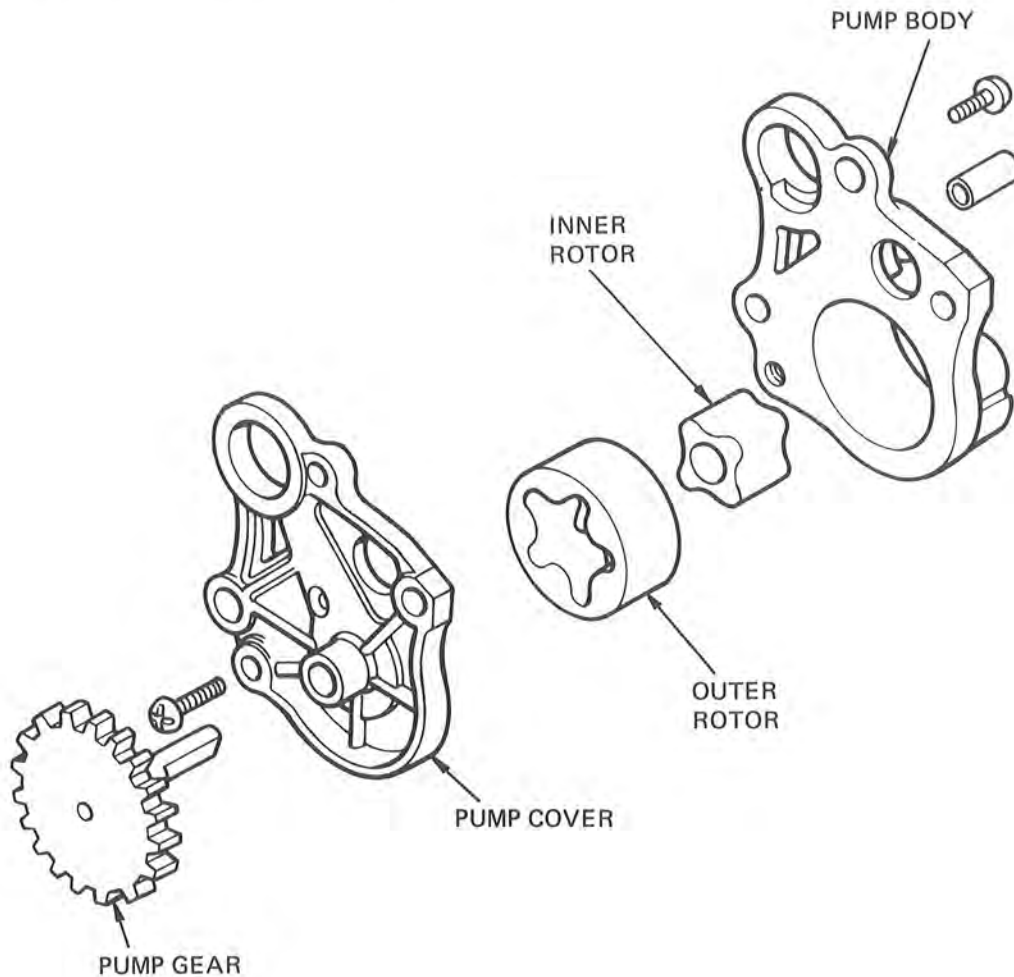

**OIL PUMP INSPECTION**

Measure the outer rotor-to-body clearance.

**SERVICE LIMIT:**  
**0.20 mm (0.008 in)**

